

Selection Guide

HHD-G, DIN Style Current-Limiting, General-Purpose

Current ratings [A]: 6.3, 8, 10, 16, 20, 25, 31.5, 40, 50, 63, 80, 100

E=192mm	Page	E=292mm	Page	E=367mm	Page	E=442mm	Page	E=537mm	Page
6 / 12kV									
		3000493.6.3	74						
		3001293.8 - 40	74						
		3002093.50 - 100	74						
10 / 24kV									
						3000693.6.3	76		
						3001493.8 - 25	76		
						3002293.31.5 - 40	76		



HHD-G
6/12kV - Rated Voltage

High Voltage Current-Limiting Fuses

For air & gas-insulated switchgear,
indoor and outdoor applications

Class

Standard(s)

DIN 43 625
IEC 60282-1
VDE 0670-4



E=292mm

General-Purpose

Rated current I_n [A]	Article Number	Diameter D [in/mm]	Weight [kg/l]	Rated breaking current I_1 [kA]	Minimum breaking current I_3 [A]	Pre-arcing I^2t [A ² s]	Total I^2t @ 0.87U _n (Max) [A ² s]	Power loss [W]	Cold resistance [mΩ]	
With 80N Striker and Temperature Limiter										
6.3	3000493.6.3	2.09 / 53	1.6	63	—	110	—	900	7	150
8	3001293.8	2.64 / 67	2.6	63	—	180	—	1 400	9	120
10	3001293.10	2.64 / 67	2.6	63	—	240	—	2 000	12	100
16	3001293.16	2.64 / 67	2.6	63	—	530	—	4 400	12	40
20	3001293.20	2.64 / 67	2.6	63	—	850	—	7 000	15	31
25	3001293.25	2.64 / 67	2.6	63	—	1 330	—	11 000	18	25
31.5	3001293.31.5	2.64 / 67	2.6	63	—	2 100	—	18 000	23	20
40	3001293.40	2.64 / 67	2.6	63	—	3 400	—	28 000	29	16
50	3002093.50	3.35 / 85	3.9	63	—	5 500	—	33 000	42	15
63	3002093.63	3.35 / 85	3.9	63	—	8 500	—	68 000	54	12
80	3002093.80	3.35 / 85	3.9	63	—	16 200	—	142 000	79	9
100	3002093.100	3.35 / 85	3.9	63	—	23 500	—	183 000	108	7.7



Dimensions [mm]

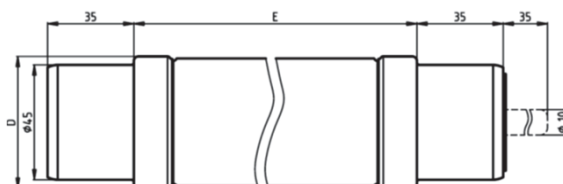

Accessories

Article Description	≤ 200A	> 200A	Page(s)
Fuse base, indoor	3100302	—	188
Fuse base, outdoor	3100401	—	189
Fuse clips	3100302.20	—	190
Fuse clips w/ connecting bar	3400201	—	
Microswitch assembly, * preferred	250mm - 3100116, 660mm - 3100110 & 3100210*, 900mm - 3100114, 1200mm - 3100117		187

SIBA LLC

29 Fairfield Place
West Caldwell, New Jersey 07006

portal: www.siballc.net
e-mail: info@sibafuse.com

HHD-G Time-Current Characteristics - Minimum Melting and Total Clearing Cut-Off Current Diagram
Current-Limiting, General-Purpose, 6/12kV, E = 292mm (6.3A - 100A)

3000493.6.3, 3001293.8 - 40, 3002093.50 - 100

Minimum Melting

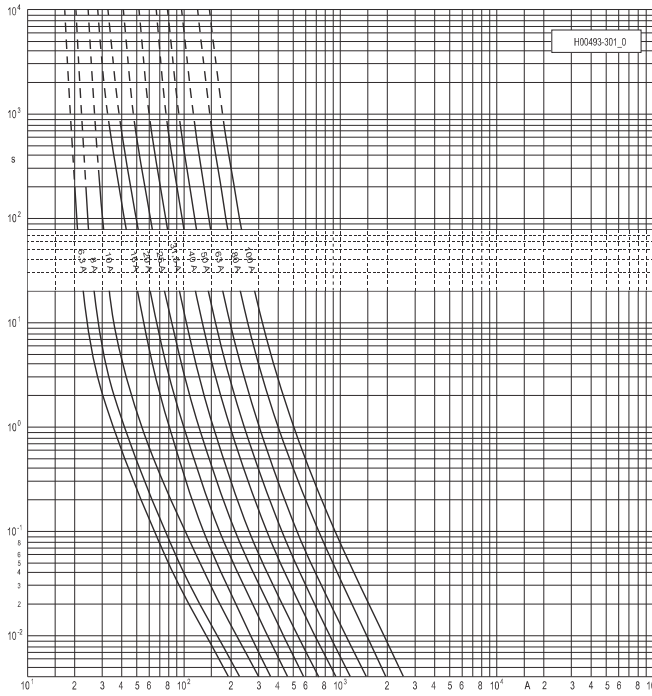

Total Clearing

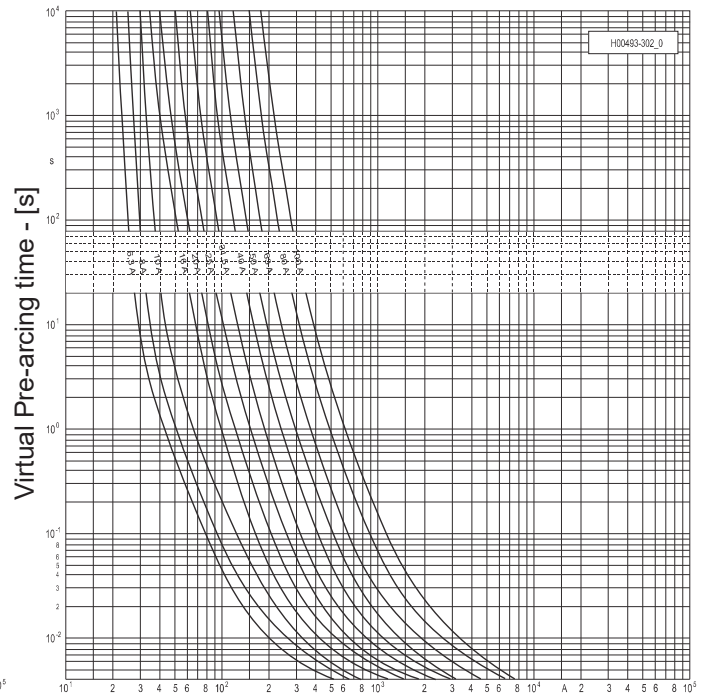

R.M.S. Prospective Current [A]

Cut-Off Current

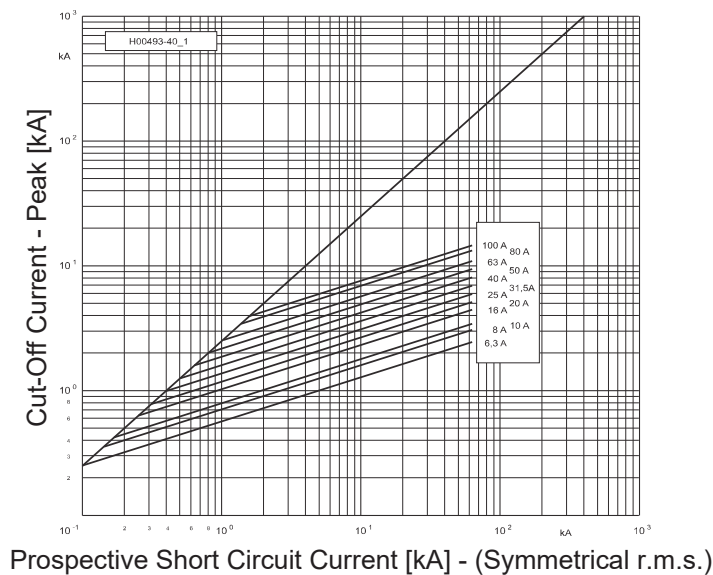

Full size graphs available upon request.

HHD-G
10/24kV - Rated Voltage

High Voltage Current-Limiting Fuses

For air & gas-insulated switchgear,
indoor and outdoor applications

Class

Standard(s)

DIN 43 625
IEC 60282-1
VDE 0670-4



E=442mm

General-Purpose

Rated current I_n [A]	Article Number	Diameter D [in/mm]	Weight [kg/l]	Rated breaking current I_1 [kA]	Minimum breaking current I_3 [A]	Pre-arcing I^2t [A ² s]	Total I^2t @ $0.87U_n(\text{Max})$ [A ² s]	Power loss [W]	Cold resistance [mΩ]	
With 80N Striker and Temperature Limiter										
6.3	3000693.6.3	2.09 / 53	2.5	40	—	110	—	900	13	273
8	3001493.8	2.64 / 67	3.7	40	—	180	—	1 400	17	220
10	3001493.10	2.64 / 67	3.7	40	—	240	—	2 000	22	160
16	3001493.16	2.64 / 67	3.7	40	—	530	—	4 400	19	70
20	3001493.20	2.64 / 67	3.7	40	—	850	—	7 000	27	55
25	3001493.25	2.64 / 67	3.7	40	—	1 330	—	11 000	38	45
31.5	3002293.31.5	3.35 / 85	5.7	40	—	2 100	—	18 000	54	41
40	3002293.40	3.35 / 85	5.7	40	—	3 400	—	28 000	77	33



Dimensions [mm]

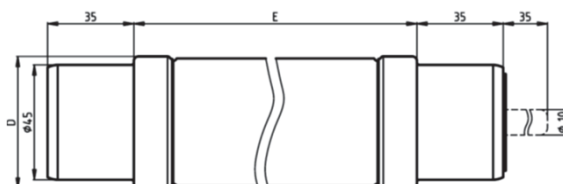

Accessories

Article Description	≤ 200A	> 200A	Page(s)
Fuse base, indoor	3100502	—	188
Fuse base, outdoor	3100601	—	189
Fuse clips	3100302.20	—	190
Fuse clips w/ connecting bar	3400201	—	
Microswitch assembly, * preferred	250mm - 3100116, 660mm - 3100110 & 3100210*, 900mm - 3100114, 1200mm - 3100117		187

SIBA LLC

29 Fairfield Place
West Caldwell, New Jersey 07006

portal: www.siballc.net
e-mail: info@sibafuse.com

**HHD-G Time-Current Characteristics - Minimum Melting and Total Clearing
Cut-Off Current Diagram
Current-Limiting, General-Purpose, 10/24kV, E = 442mm (6.3A - 40A)**

3000693.6.3, 3001493.8 - 25, 3002293.31.5 - 40

Minimum Melting

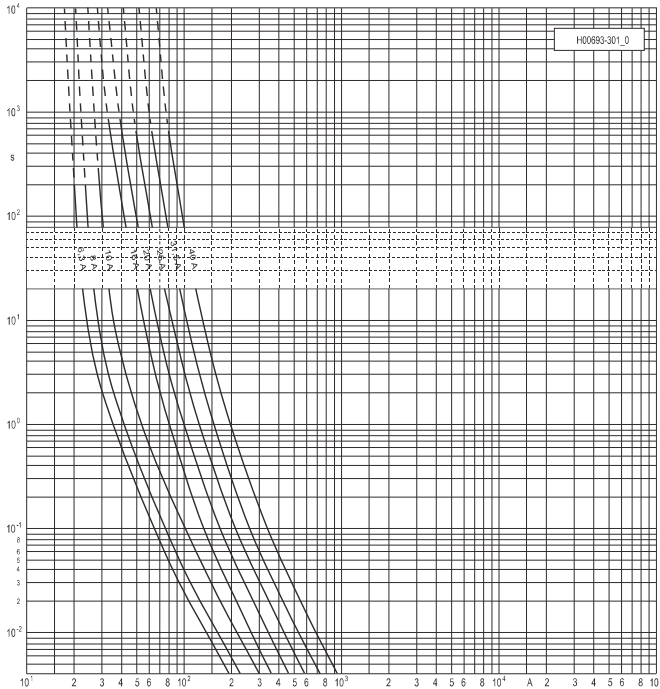

Total Clearing

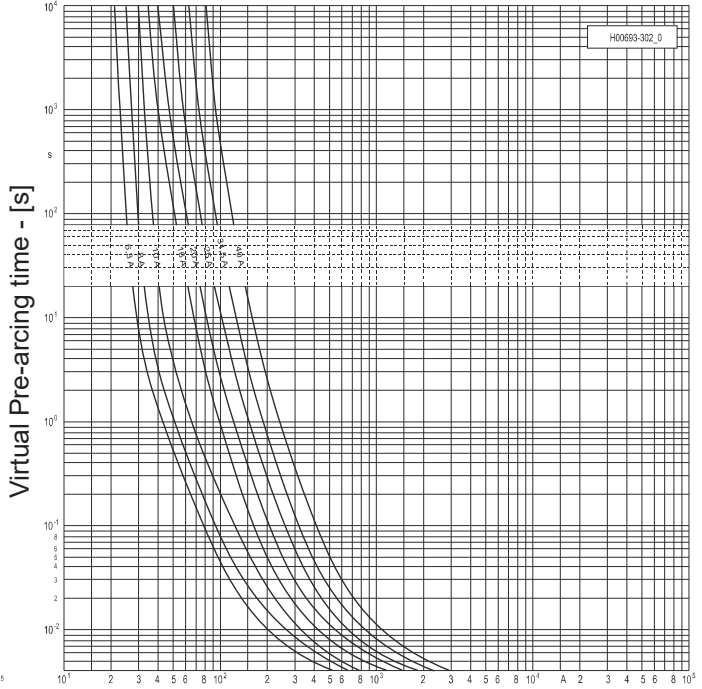

R.M.S. Prospective Current [A]

Cut-Off Current

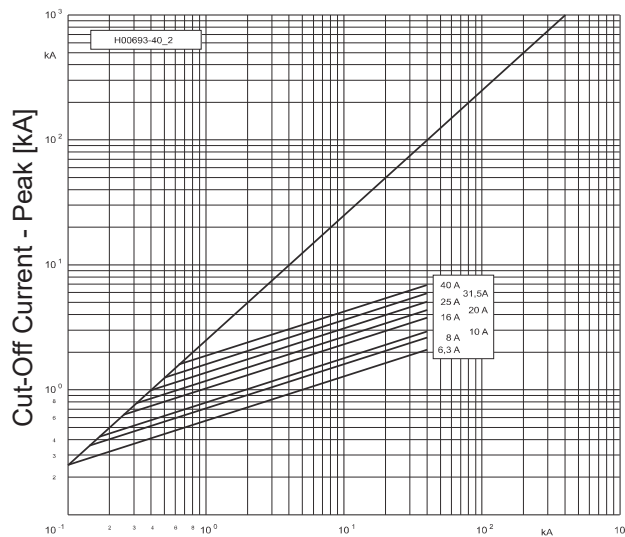

Prospective Short Circuit Current [kA] - (Symmetrical r.m.s.)

Full size graphs available upon request.