

# HHPT HH\*-BVT High Voltage Fuses Special Purpose

## Application Range Types

### Fuses for Protection of Potential(Voltage) Transformers - (PT / VT)

SIBA HHPT series of special purpose fuses are current-limiting “Back-Up” class for the protection of “potential transformers” (PT) based on SIBA’s own “Company Standard”. These specially designed fuses have excellent current-limiting properties with the capability of isolating the faulty potential transformer in a matter of milliseconds from the grid. The fuses are available in 3/7.2kV, 6/12kV, 10/17.5kV, 20/36kV and 40.5kV, having current ratings from 0.5A – 5A without strikers, 2A -5A with strikers are available in two diameters, 24mm and 39.6mm with body lengths commensurate to the rated voltage.

SIBA HPT fuses are also available with E ratings per IEEE Standard C37.41 and are available in 2.4/7.2kV, 8.3/15.5kV 8.3/17.5kV, 23/36kV an 38.5kV having current ratings from 0.5E – 7E without strikers, available in two diameters, 24mm and 39.6mm with body lengths commensurate to the rated voltage.

The first criteria is the system operating voltage, the rated voltage of the fuse must exceed the system operating voltage. Under normal operating conditions, the voltage transformer’s load current is usually much less than 1A. The fuse is selected to withstand worst case transients. The transient currents (such as inrush during energizing) should be plotted on the fuses’ TCC (Time-Current Characteristic) curve for determining discrimination. A discrimination safety margin of 1:2 is recommended to avoid nuisance tripping.

### NEW - E-Rated fuses per IEEE C37-41 -2008



\* Z - Cylindrical

\* DIN

## Selection Guide

### HHPT, Current-Limiting, Back-Up, Potential Transformer Protection(PT)

Current ratings [A]; 0.3, 0.5, 1, 2, 3, 4, 5

L=142mm	Page	L=195mm	Page	L=220mm	Page	L=340mm	Page	L=359mm	Page
<b>3/7.2kV</b>									
3038311.0.5 - 3	136	3037711.0.5 - 3	136	3037111.0.5 - 5	136				
<b>6/12kV</b>									
		3037811.0.5 - 3	137	3037211.0.5 - 5	137				
<b>10/17.5kV</b>									
				3044411.0.5 - 3	138	3037311.0.5 - 5	138	3037911.0.5 - 3	138
L=240mm	Page	L=310mm	Page	L=340mm	Page	L=359mm	Page	L=440mm	Page
<b>10/24kV</b>									
		3050611.0.5 - 3	139	3037411.0.5 - 5	139	3038011.0.5 - 3	139		
<b>20/36kV</b>									
						3038111.1 - 3	140	3037511.0.5 - 3	140

**New - HHPT Fuse body is special ceramic suitable for encapsulation within the PT isolator terminal.**

Current ratings [A]; 0.3, 0.5, 1, 2, 3, 4, 5

L1=111mm	Page	L1=186mm	Page	L1=240mm	Page	L1=286mm	Page	L1=326mm	Page
<b>2 / 7.2kV</b>									
3051611.2 - 5	142								
<b>8.3 / 15.5kV</b>									
		3051711.1 - 5	142						
<b>10 / 24kV</b>									
				3050811.1 - 5	142				
<b>17.5 / 27kV</b>									
						3051811.1 - 3	142		
<b>40.5kV</b>									
								3050911.0.3 - 1	142

### New, HHPT Current Limiting E-Rated Fuses per IEEE C37-41

Current ratings [A]; 0.5E, 0.75E, 1E , 2E , 3E , 4E, 5E, 7E

L=142mm	Page	L=195mm	Page	L=327mm		L=340mm	Page	L=359mm	Page
<b>2.4/7.2kV</b>									
3038311.0.5E - 4E	144	3037711.0.5E - 7E	144						
<b>8.3/15.5kV</b>									
				3043511.0.5E - 7E	145				
<b>8.3/17.5kV</b>									
								3037911.0.5E - 7E	144
<b>23/36kV</b>									
								3038111.0.5E -1E	144
<b>38.5kV</b>									
Contact SIBA									

## Selection Guide

### HHPT, Current-Limiting, Back-Up, Potential Transformer Protection(PT)

Current ratings [A]; 0.1, 0.2, 0.3, 0.5, 0.6, 1, 2, 3.15, 4, 5, 6.3

L=160mm	Page	L=250mm	Page	L=280mm		L=418mm	Page	L=	Page
<b>6 / 12kV</b>									
3044011.0.1 - 6.3	147								
<b>10 / 36kV</b>									
		3044311.0.1 - 2	147	3044111.0.1 - 6.3	147				
<b>20 / 36kV</b>									
						3044211.0.1 - 2	147		

### HHD-BVT, DIN Style, Current-Limiting, Back-Up, Potential Transformer Protection

Current ratings [A]; 0.5, 1, 2, 2.5, 3.15, 4, 5

E=192mm	Page	E=292mm	Page	E=367mm	Page	E=442mm	Page	E=537mm	Page
<b>3 / 7.2kV</b>									
3000211.0.5 - 5	149	3009811.0.5 - 5	149						
3000213.2 - 5	149	3009813.2 - 5	149						
<b>6 / 12kV</b>									
3011911.0.5 - 5	150	3000411.0.5 - 5	150						
3011913.2 - 5	150	3000413.2 - 5	150						
<b>10 / 17.5kV</b>									
3017911.0.5 - 5	151	3025511.0.5 - 5	151						
3017913.2 - 5	151	3025513.2 - 5	151						
				3017611.0.5 - 5	152	3023111.0.5 - 5	152		
				3017613.2 - 5	152	3023113.2 - 5	152		
<b>10 / 24kV</b>									
		3018011.0.5 - 5	153			3000611.0.5 - 5	153		
		3018013.2 - 5	153			3000613.2 - 5	153		
<b>20 / 36kV</b>									
		3038211.0.5 - 5	154			3018111.0.5 - 5	155	3000811.0.5 - 5	155
		3038213.2 - 5	154			3018113.2 - 5	155	3000813.2 - 5	155
<b>38.5kV</b>									
								3033711.0.5 - 5	156
								3033713.2 - 5	156
<b>40.5kV</b>									
								3034011.0.5 - 5	157
								3034013.2 - 5	157



### HHZ-BVT

3/7.2kV- Rated Voltage

### High Voltage Current-Limiting Fuses

For PT Transformers  
without Striker

Class

Back-Up

Standard(s)

Company Standard



L = 142mm/195mm/220mm

Rated current $I_n$ [A]	Article Number	Diameter D [in/mm]	Weight [kg/1]	Rated breaking current $I_1$ [kA]	Minimum breaking current $I_3$ [A]	Pre-arcing $I^2t$ [A <sup>2</sup> s]	Total $I^2t$ @ $0.87U_n(\text{Max})$ [A <sup>2</sup> s]	Power loss [W]	Cold resistance [mΩ]
<b>L = 142mm</b>									
0.5	3038311.0.5	0.94 / 24	0.2	63	2.5	0.1	—	0.9	1.9
1	3038311.1	0.94 / 24	0.2	63	8	0.6	—	1.9	3.2
2	3038311.2	0.94 / 24	0.2	63	12	3.2	—	9.9	5.8
3	3038311.3	0.94 / 24	0.2	63	2	16.1	—	47.8	6.3
<b>L = 195mm</b>									
0.5	3037711.0.5	0.94 / 24	0.2	63	2.5	0.1	—	0.9	1.9
1	3037711.1	0.94 / 24	0.2	63	8	0.6	—	1.9	3.2
2	3037711.2	0.94 / 24	0.2	63	12	3.2	—	9.9	5.8
3	3037711.3	0.94 / 24	0.2	63	24	16.1	—	47.8	6.3
<b>L = 220mm</b>									
0.5	3037111.0.5	1.56 / 39.6	0.7	63	2.5	0.1	—	0.9	1.9
1	3037111.1	1.56 / 39.6	0.7	63	8	0.6	—	1.9	3.1
2	3037111.2	1.56 / 39.6	0.7	63	12	3.2	—	9.9	5.5
3	3037111.3	1.56 / 39.6	0.7	63	24	16.1	—	47.8	6.1
4	3037111.4	1.56 / 39.6	0.7	63	32	28.9	—	85.3	7.4
5	3037111.5	1.56 / 39.6	0.7	63	40	40.9	—	120.7	9.0

### Dimensions [mm]

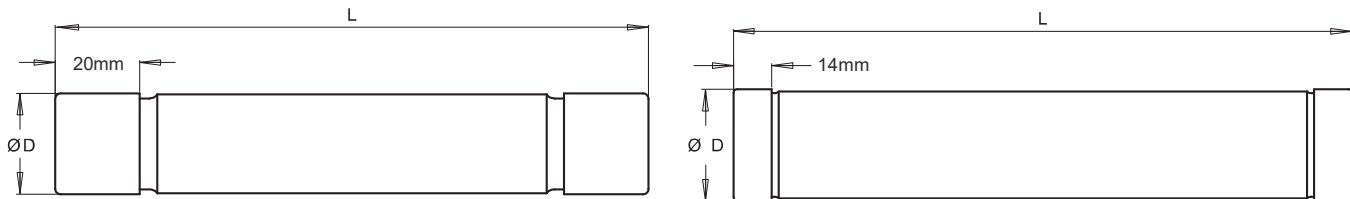

### Accessories

Article Description	Article Number	D[in/mm]	Page(s)
Fuse clips	6100201.3	0.94 / 24	192
Terminal bar for fuse clips	6100201.4	—	
Fuse clips	9109401.3	1.56 / 39.6	—
Terminal bar for fuse clips	9109401.4	—	
Fuse base	Contact SIBA	—	—

SIBA LLC

29 Fairfield Place  
West Caldwell, New Jersey 07006

portal: [www.siballc.net](http://www.siballc.net)  
e-mail: [info@sibafuse.com](mailto:info@sibafuse.com)

**HHZ-BVT**  
6/12kV - Rated Voltage

**High Voltage Current-Limiting Fuses**

For PT Transformers  
without Striker

Class

Back-Up

Standard(s)

Company Standard



L = 195mm/220mm

Rated current $I_n$ [A]	Article Number	Diameter <b>D</b> [in/mm]	Weight [kg/1]	Rated breaking current $I_1$ [kA]	Minimum breaking current $I_3$ [A]	Pre-arcing $I^2t$ [A <sup>2</sup> s]	Total $I^2t$ @ 0.87U <sub>n</sub> (Max) [A <sup>2</sup> s]	Power loss [W]	Cold resistance [mΩ]
<b>L = 195mm</b>									
0.5	3037811.0.5	0.94 / 24	0.2	63	2.5	0.1	—	0.9	3.5
1	3037811.1	0.94 / 24	0.2	63	8	0.6	—	1.9	5.5
2	3037811.2	0.94 / 24	0.2	63	12	3.2	—	9.9	10
3	3037811.3	0.94 / 24	0.2	63	24	16.1	—	47.8	11
<b>L = 220mm</b>									
0.5	3037211.0.5	1.56 / 39.6	0.7	63	2.5	0.1	—	0.9	3.3
1	3037211.1	1.56 / 39.6	0.7	63	8	0.6	—	1.9	5.3
2	3037211.2	1.56 / 39.6	0.7	63	12	3.2	—	9.9	9.4
3	3037211.3	1.56 / 39.6	0.7	63	24	16.1	—	47.8	11
4	3037211.4	1.56 / 39.6	0.7	63	32	28.9	—	85.3	12
5	3037211.5	1.56 / 39.6	0.7	63	40	40.9	—	120.7	16

**Dimensions [mm]**

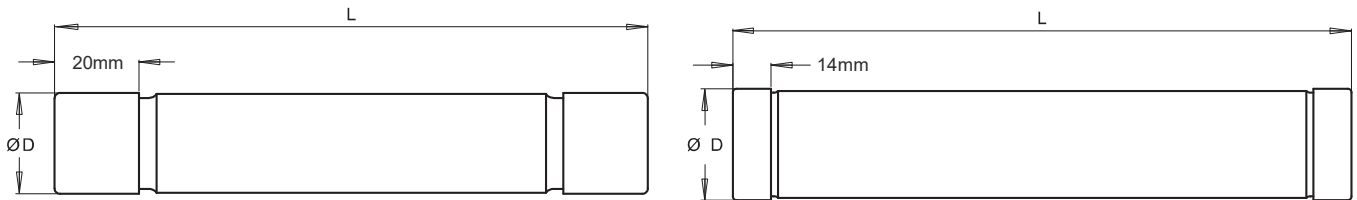

**Accessories**

Article Description	Article Number	D[in/mm]	Page(s)
Fuse clips	6100201.3	0.94 / 24	192
Terminal bar for fuse clips	6100201.4	—	
Fuse clips	9109401.3	1.56 / 39.6	
Terminal bar for fuse clips	9109401.4	—	
Fuse base	Contact SIBA		—

### HHZ-BVT

10/17.5kV- Rated Voltage

### High Voltage Current-Limiting Fuses

For PT Transformers

without Striker

Class

Back-Up

Standard(s)

Company Standard

L = 220mm/340mm/359mm



Rated current $I_n$ [A]	Article Number	Diameter <b>D</b> [in/mm]	Weight [kg/l]	Rated breaking current $I_1$ [kA]	Minimum breaking current $I_3$ [A]	Pre-arcing $I^2t$ [A <sup>2</sup> s]	Total $I^2t$ @ $0.87U_n(\text{Max})$ [A <sup>2</sup> s]	Power loss [W]	Cold resistance [mΩ]	
<b>L = 220mm</b>										
0.5	3044411.0.5	1.56 / 39.6	0.7	63	2.5	0.1	—	0.9	4.4	—
1	3044411.1	1.56 / 39.6	0.7	63	8	0.6	—	1.9	7.4	—
2	3044411.2	1.56 / 39.6	0.7	63	12	3.2	—	9.9	13	—
3	3044411.3	1.56 / 39.6	0.7	63	24	16.1	—	47.8	15	—
<b>L = 340mm</b>										
0.5	3037311.0.5	1.56 / 39.6	1.1	63	2.5	0.1	—	0.9	4.4	—
1	3037311.1	1.56 / 39.6	1.1	63	8	0.6	—	1.9	7.4	—
2	3037311.2	1.56 / 39.6	1.1	63	12	3.2	—	9.9	13	—
3	3037311.3	1.56 / 39.6	1.1	63	24	16.1	—	47.8	15	—
4	3037311.4	1.56 / 39.6	1.1	63	32	28.9	—	85.3	20	—
5	3037311.5	1.56 / 39.6	1.1	63	40	40.9	—	120.7	24	—
<b>L = 359mm</b>										
0.5	3037911.0.5	0.94 / 24	0.7	63	2.5	0.1	—	0.9	4.5	—
1	3037911.1	0.94 / 24	0.7	63	8	0.6	—	1.9	8	—
2	3037911.2	0.94 / 24	0.7	63	12	3.2	—	9.9	13	—
3	3037911.3	0.94 / 24	0.7	63	24	16.1	—	47.8	16	—

### Dimensions [mm]

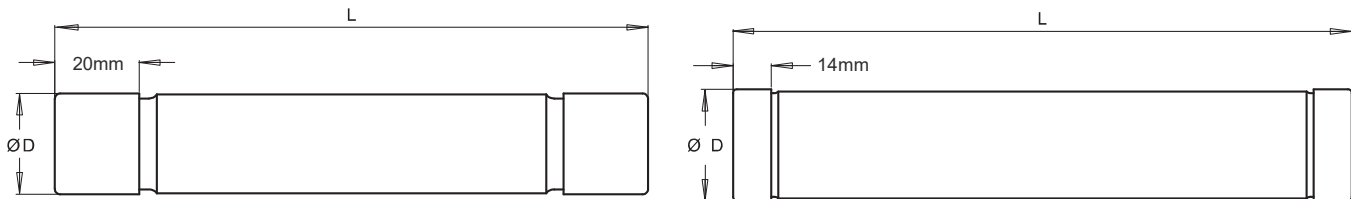

### Accessories

Article Description	Article Number	D[in/mm]	Page(s)
Fuse clips	6100201.3	0.94 / 24	192
Terminal bar for fuse clips	6100201.4	—	
Fuse clips	9109401.3	1.56 / 39.6	
Terminal bar for fuse clips	9109401.4	—	
Fuse base	Contact SIBA	—	

**HHZ-BVT** **Standard(s)**  
Company Standard  
**10/24kV- Rated Voltage** **High Voltage Current-Limiting Fuses**  
For PT Transformers  
without Striker  
**L = 310mm/340mm/359mm** **Class**  
Back-Up

Rated current $I_n$ [A]	Article Number	Diameter <b>D</b> [in/mm]	Weight [kg/l]	Rated breaking current $I_1$ [kA]	Minimum breaking current $I_3$ [A]	Pre-arcing $I^2t$ [A <sup>2</sup> s]	Total $I^2t$ @ 0.87U <sub>n</sub> (Max) [A <sup>2</sup> s]	Power loss [W]	Cold resistance [mΩ]
<b>L = 310mm</b>									
0.5	3050611.0.5	0.94 / 24	0.8	63	2.5	0.1	—	0.9	6.1
1	3050611.1	0.94 / 24	0.8	63	8	0.6	—	1.9	10
2	3050611.2	0.94 / 24	0.8	63	12	3.2	—	9.9	16
3	3050611.3	0.94 / 24	0.8	63	24	16.1	—	47.8	18
<b>L = 340mm</b>									
0.5	3037411.0.5	1.56 / 39.6	1.1	63	2.5	0.1	—	0.9	6
1	3037411.1	1.56 / 39.6	1.1	63	8	0.6	—	1.9	9
2	3037411.2	1.56 / 39.6	1.1	63	12	3.2	—	9.9	15
3	3037411.3	1.56 / 39.6	1.1	63	24	16.1	—	47.8	17
4	3037411.4	1.56 / 39.6	1.1	63	32	28.9	—	85.3	26
5	3037411.5	1.56 / 39.6	1.1	63	40	40.9	—	120.7	31
<b>L = 359mm</b>									
0.5	3038011.0.5	0.94 / 24	0.8	63	2.5	0.1	—	0.9	6.1
1	3038011.1	0.94 / 24	0.8	63	8	0.6	—	1.9	10
2	3038011.2	0.94 / 24	0.8	63	12	3.2	—	9.9	16
3	3038011.3	0.94 / 24	0.8	63	24	16.1	—	47.8	18

**Dimensions [mm]**

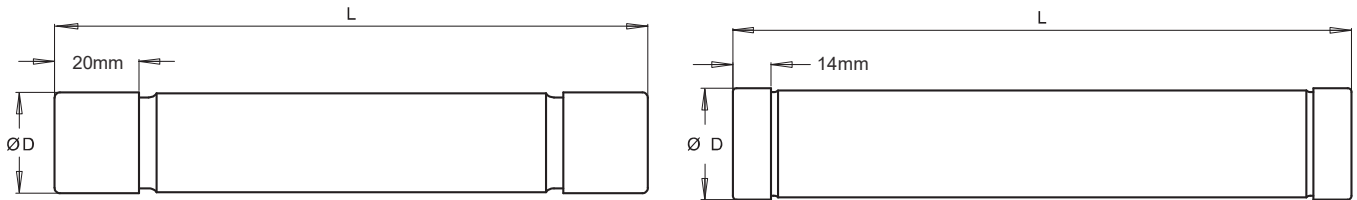

**Accessories**

Article Description	Article Number	D[in/mm]	Page(s)
Fuse clips	6100201.3	0.94 / 24	192
Terminal bar for fuse clips	6100201.4	—	
Fuse clips	9109401.3	1.56 / 39.6	
Terminal bar for fuse clips	9109401.4	—	
Fuse base	Contact SIBA		—

**HHZ-BVT**  
20/36kV- Rated Voltage

**High Voltage Current-Limiting Fuses**  
For PT Transformers  
without Striker

Standard(s)  
Company Standard



**L = 359mm/440mm**

Class  
Back-Up

Rated current $I_n$ [A]	Article Number	Diameter <b>D</b> [in/mm]	Weight [kg/1]	Rated breaking current $I_1$ [kA]	Minimum breaking current $I_3$ [A]	Pre-arcing $I^2t$ [A <sup>2</sup> s]	Total $I^2t$ @ $0.87U_n(\text{Max})$ [A <sup>2</sup> s]	Power loss [W]	Cold resistance [mΩ]	
<b>L = 359mm</b>										
0.5	3038111.0.5	0.94 / 24	0.8	63	2.5	0.1	—	0.9	11	—
1	3038111.1	0.94 / 24	0.8	63	8	0.6	—	1.9	15	—
2	3038111.2	0.94 / 24	0.8	63	12	3.2	—	9.9	24	—
3	3038111.3	0.94 / 24	0.8	63	24	16.1	—	47.8	28	—
<b>L = 440mm</b>										
0.5	3037511.0.5	1.56 / 39.6	1.2	63	2.5	0.1	—	0.9	10	—
1	3037511.1	1.56 / 39.6	1.2	63	8	0.6	—	1.9	14	—
2	3037511.2	1.56 / 39.6	1.2	63	12	3.2	—	9.9	23	—
3	3037511.3	1.56 / 39.6	1.2	63	24	16.1	—	47.8	26	—

### Dimensions [mm]

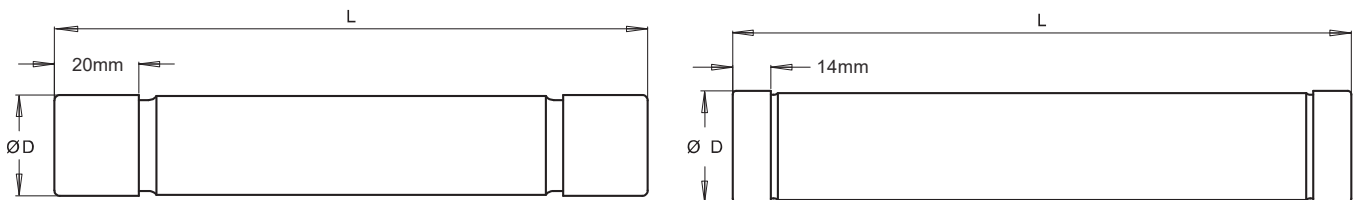

### Accessories

Article Description	Article Number	D[in/mm]	Page(s)
Fuse clips	6100201.3	0.94 / 24	192
Terminal bar for fuse clips	6100201.4	—	
Fuse clips	9109401.3	1.56 / 39.6	
Terminal bar for fuse clips	9109401.4	—	
Fuse base	Contact SIBA		—

SIBA LLC

29 Fairfield Place  
West Caldwell, New Jersey 07006



**HHZ-BVT Time-Current Characteristics - Minimum Melting and Total Clearing  
Cut-Off Current Diagram  
Current-Limiting, Back-Up, 3kV - 36kV (0.5A - 5A)**

30xxx11.1 - 3; xxx = 375, 377, 378, 379, 380, 381, 383, 444  
30xxx11.1 - 5; xxx = 371, 372, 373, 374

**Minimum Melting**

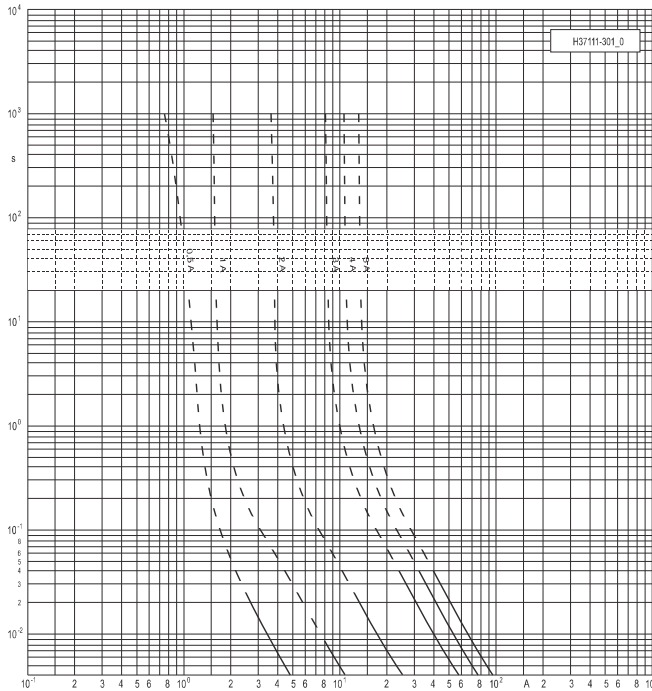

**Total Clearing**

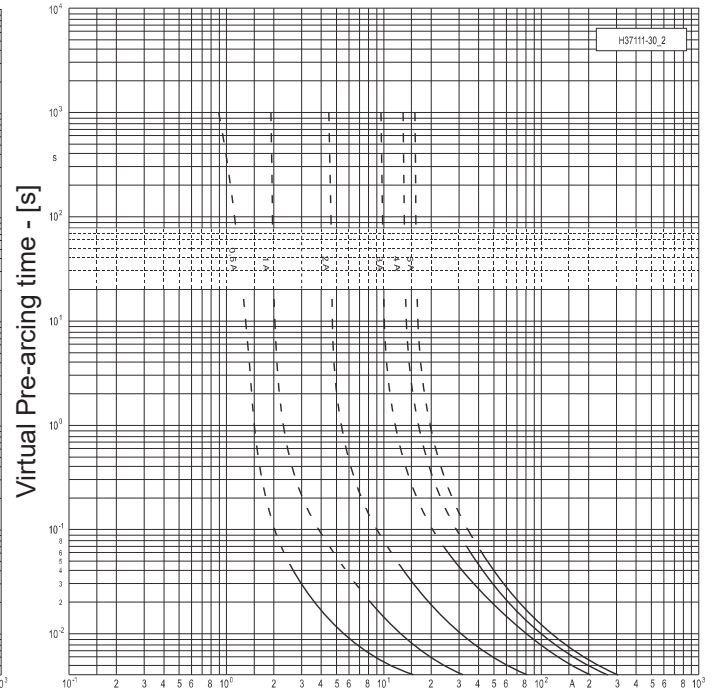

R.M.S. Prospective Current [A]

**Cut-Off Current**

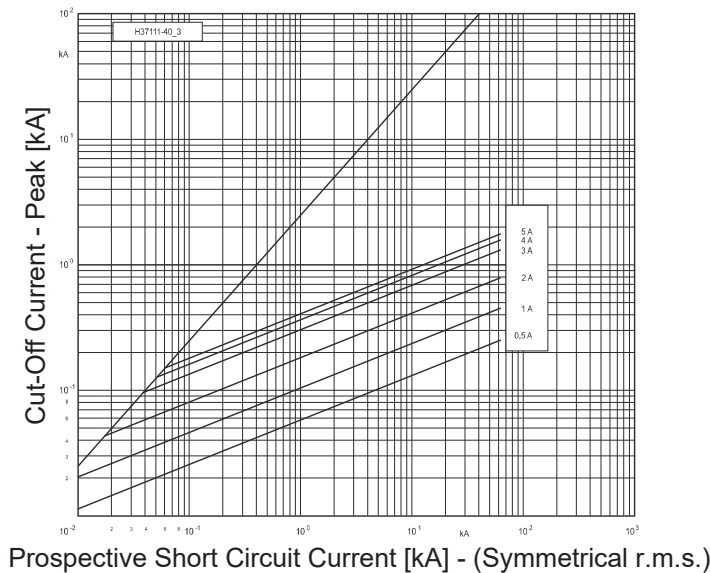

Full size graphs available upon request.

**HHZ-BVT** **Standard(s)**  
Company Standard  
**2kV - 40.5kV- Rated Voltage** **High Voltage Current-Limiting Fuses**  
For PT Transformers  
without Striker  
**Class**   
**L1 = 111mm/ 186mm/ 240mm/ 286mm/ 326mm** **Back-Up**

Rated current $I_n$ [A]	Article Number	Diameter <b>D</b> [in/mm]	Weight [kg/1]	Rated breaking current $I_1$ [kA]	Minimum breaking current $I_3$ [A]	Pre-arcing $I^2t$ [A <sup>2</sup> s]	Total $I^2t$ @ 0.87U <sub>n</sub> (Max) [A <sup>2</sup> s]	Power loss [W]	Cold resistance [mΩ]	
<b>2.4 / 7.2kV, L1 = 111mm</b>										
1	3051611.1	1.56 / 39.6	—	63	8	0.6	—	2	3.1	—
2	3051611.2	1.56 / 39.6	—	63	12	3.2	—	10	5.5	—
3	3051611.3	1.56 / 39.6	—	63	24	16	—	48	6.1	—
4	3051611.4	1.56 / 39.6	—	63	32	29	—	85	7.4	—
5	3051611.5	1.56 / 39.6	—	63	40	41	—	121	9.0	—
<b>8.3 / 15.5kV, L1 = 186mm</b>										
1	3051711.1	1.56 / 39.6	—	63	8	0.6	—	2	7	—
2	3051711.2	1.56 / 39.6	—	63	12	3.2	—	10	13	—
3	3051711.3	1.56 / 39.6	—	63	24	16	—	48	15	—
4	3051711.4	1.56 / 39.6	—	63	32	29	—	85	20	—
5	3051711.5	1.56 / 39.6	—	63	40	41	—	121	24	—
<b>10 / 24kV, L1 = 240mm</b>										
1	3050811.1	1.56 / 39.6	—	63	8	0.6	—	2	9	—
2	3050811.2	1.56 / 39.6	—	63	12	3.2	—	10	15	—
3	3050811.3	1.56 / 39.6	—	63	24	16	—	48	17	—
4	3050811.4	1.56 / 39.6	—	62	32	29	—	85	26	—
5	3050811.5	1.56 / 39.6	—	63	40	41	—	121	31	—
<b>17.5 / 27kV, L1 = 286mm</b>										
1	3051811.1	1.56 / 39.6	—	40	8	0.6	—	2	9	—
2	3051811.2	1.56 / 39.6	—	40	12	3.2	—	10	16	—
3	3051811.3	1.56 / 39.6	—	40	24	16	—	48	19	—
<b>40.5kV, L1 = 326mm</b>										
0.3	3050911.0.3	1.56 / 39.6	1.1	25	2.7	0.11	—	0.9	5	—
0.5	3050911.0.5	1.56 / 39.6	1.1	25	4.5	0.2	—	1.8	8	—
1	3050911.1	1.56 / 39.6	1.1	25	8	0.6	—	1.9	14	—

New - HHPT Fuse body is special ceramic suitable for encapsulation within the PT isolator terminal.

### Dimensions [mm]

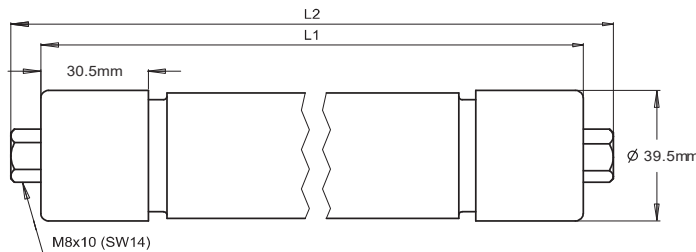

	Dimensions		
	[in/mm]		
	D	L1	L2
<b>3051611</b>	1.56 / 39.6	4.37 / 111	5.04 / 128
<b>3050811</b>		7.32 / 186	2.48 / 203
<b>3051711</b>		9.45 / 240	10.11 / 257
<b>3051811</b>		11.26 / 286	11.93 / 303
<b>3050011</b>		12.83 / 326	13.50 / 343

**HHZ-BVT Time-Current Characteristics - Minimum Melting and Total Clearing  
Cut-Off Current Diagram  
Current-Limiting, Back-Up, 3kV - 36kV (0.5A - 5A)**

3051611.0.1 -5, 3051711.1 -5, 2050811.1 -5, 3051811.1 -3, 3050911.0.3 -1

**Average Melting**

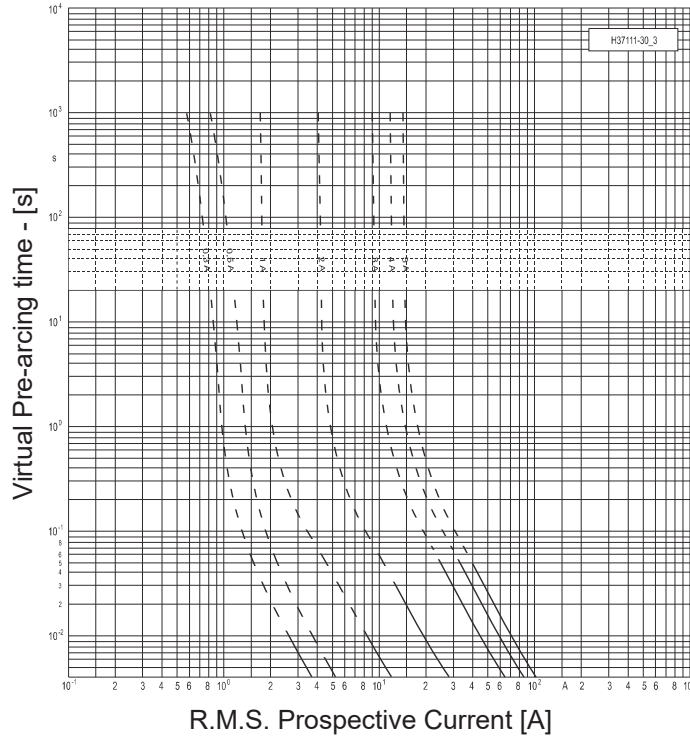

**Cut-Off Current**

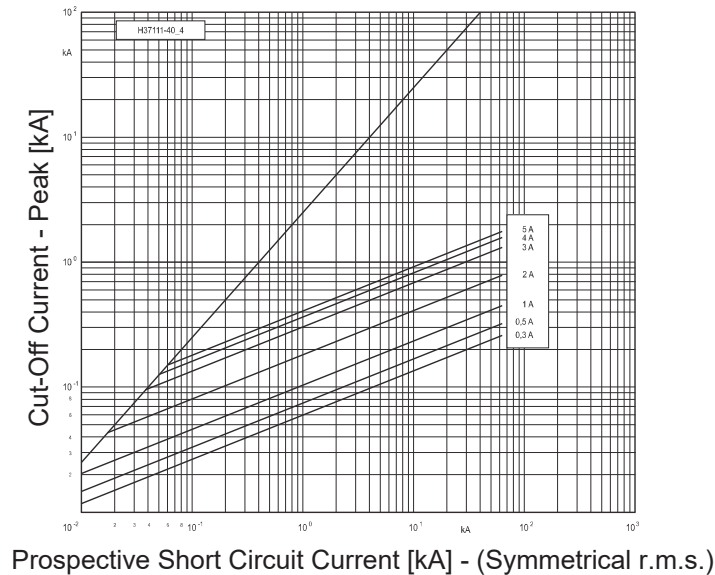

Full size graphs available upon request.

**HHZ-BVT**  
2.4kV- 36kV- Rated Voltage  
E-Rated

**High Voltage Current-Limiting Fuses**

Standard(s)

For PT Transformers

IEEE C37.41

without Striker

Class

Back-Up

L = 142mm/195mm/327mm/359mm

Rated current $I_n$ [A]	Article Number	Diameter <b>D</b> [in/mm]	Weight [kg/1]	Rated breaking current $I_1$ [kA]	Minimum breaking current $I_3$ [A]	Pre-arcing $I^2t$ [A <sup>2</sup> s]	Total $I^2t$ @ $U_n(\text{Max})$ [A <sup>2</sup> s]	Power loss [W]	Cold resistance [mΩ]	
<b>2.4/7.2kV - L = 142mm</b>										
0.5	3038311.0.5E	0.94 / 24	0.8	80	—	0.1	—	0.9	1.9	—
0.75	3038311.0.75E	0.94 / 24	0.8	80	—	0.4	—	3.5	2.2	—
1	3038311.1E	0.94 / 24	0.8	80	—	1	—	9	2.6	—
2	3038311.2E	0.94 / 24	0.8	80	—	4	—	38	5	—
3	3038311.3E	0.94 / 24	0.8	80	—	16	—	155	6	—
4	3038311.4E	0.94 / 24	0.8	80	—	25	—	235	9	—
<b>2.4/7.2kV - L = 195mm</b>										
0.5	3037711.0.5E	0.94 / 24	0.8	80	—	0.1	—	0.9	1.9	—
0.75	3037711.0.75E	0.94 / 24	0.8	80	—	0.4	—	3.5	2.2	—
1	3037711.1E	0.94 / 24	0.8	80	—	1	—	9	2.6	—
2	3037711.2E	0.94 / 24	0.8	80	—	4	—	38	5	—
3	3037711.3E	0.94 / 24	0.8	80	—	16	—	155	6	—
4	3037711.4E	0.94 / 24	0.8	80	—	25	—	235	9	—
5	3037711.5E	0.94 / 24	0.8	80	—	44	—	280	10	—
7	3037711.7E	0.94 / 24	0.8	80	—	130	—	610	13	—
<b>8.3/17.5kV - L = 359mm</b>										
0.5	3037911.0.5E	0.94 / 24	0.8	70	—	0.1	—	0.9	4.4	—
0.75	3037911.0.75E	0.94 / 24	0.8	70	—	0.4	—	3.5	5.2	—
1	3037911.1E	0.94 / 24	0.8	70	—	1	—	9	—	—
2	3037911.2E	0.94 / 24	0.8	70	—	4	—	38	8	—
3	3037911.3E	0.94 / 24	0.8	70	—	16	—	155	15	—
4	3037911.4E	0.94 / 24	0.8	70	—	25	—	235	20	—
5	3037911.5E	0.94 / 24	0.8	70	—	44	—	280	25	—
7	3037911.7E	0.94 / 24	0.8	70	—	130	—	610	30	—
<b>20/36kV - L = 359mm</b>										
0.5	3038111.0.5E	0.94 / 24	0.8	25	—	0.1	—	0.9	8.6	—
0.75	3038111.0.75E	0.94 / 24	0.8	25	—	0.4	—	3.5	10.5	—
1	3038111.1E	0.94 / 24	0.8	25	—	1	—	10	13	—

**Dimensions [mm]**

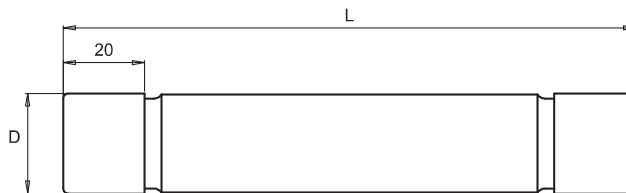

**Accessories**

Article Description	Article Number	D[in/mm]	Page(s)
Fuse clips	6100201.3	0.94 / 24	192
Terminal bar for fuse clips	6300201.4	—	
Clamping plate	6300201	—	

**HHZ-BVT** **High Voltage Current-Limiting Fuses**  
**8.3kV - 15.5kV - Rated Voltage** **For PT Transformers**  
**E-Rated** **without Striker**  
**L = 142mm/195mm/327mm/359mm** **Class**  
**Back-Up**

**Standard(s)**  
IEEE C37.41



Rated current $I_n$ [A]	Article Number	Diameter <b>D</b> [in/mm]	Weight [kg/1]	Rated breaking current $I_1$ [kA]	Minimum breaking current $I_3$ [A]	Pre-arcing $I^2t$ [A <sup>2</sup> s]	Total $I^2t$ @ $U_n(\text{Max})$ [A <sup>2</sup> s]	Power loss [W]	Cold resistance [mΩ]	
<b>8.3/15.5kV - L = 327mm</b>										
0.5	3043511.0.5E	1.56 / 39.6	0.8	70	—	0.1	—	0.8	4.3	—
0.75	3043511.0.75E	1.56 / 39.6	0.8	70	—	0.4	—	3.2	5	—
1	3043511.1E	1.56 / 39.6	0.8	70	—	1	—	8.6	5.8	—
2	3043511.2E	1.56 / 39.6	0.8	70	—	4	—	34	7.7	—
3	3043511.3E	1.56 / 39.6	0.8	70	—	16	—	143	14.9	—
4	3043511.4E	1.56 / 39.6	0.8	70	—	25	—	215	19	—
5	3043511.5E	1.56 / 39.6	0.8	70	—	44	—	265	24	—
7	3043511.7E	1.56 / 39.6	0.8	70	—	130	—	580	29	—

**Dimensions [mm]**

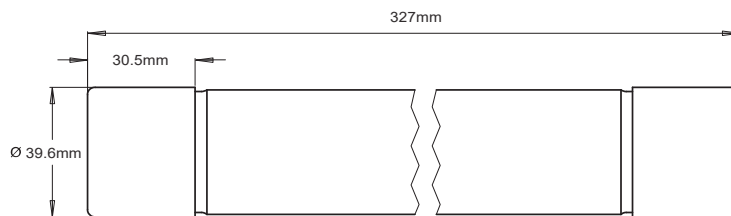

**Accessories**

Article Description	Article Number	D[in/mm]	Page(s)
Fuse clips	9109401.3	1.56 / 39.6	192
Terminal bar for fuse clips	9109401.4	—	

**HHZ-BVT**  
2.4kV- 36kV - Rated Voltage  
**E-Rated**

**L = 142mm/195mm/327mm/359mm**

**High Voltage Current-Limiting Fuses**

For PT Transformers  
without Striker

**Class**  
**Back-Up**

**Standard(s)**

IEEE C37.41



3038311.0.5E - 4E, 3037711.0.5E - 7E, 3037911.0.5E - 7E, 3038111.0.5E - 1E, 3043511.0.5E - 7E

**Minimum Melting**

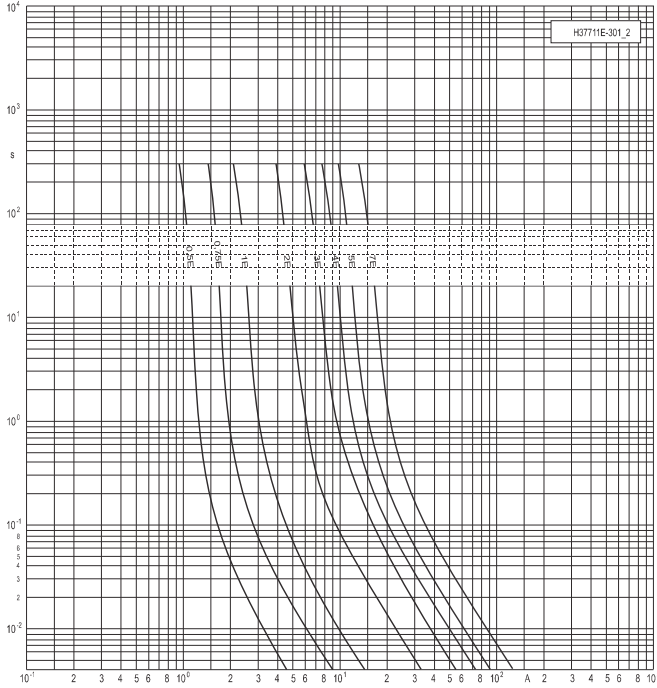

**Total Clearing**

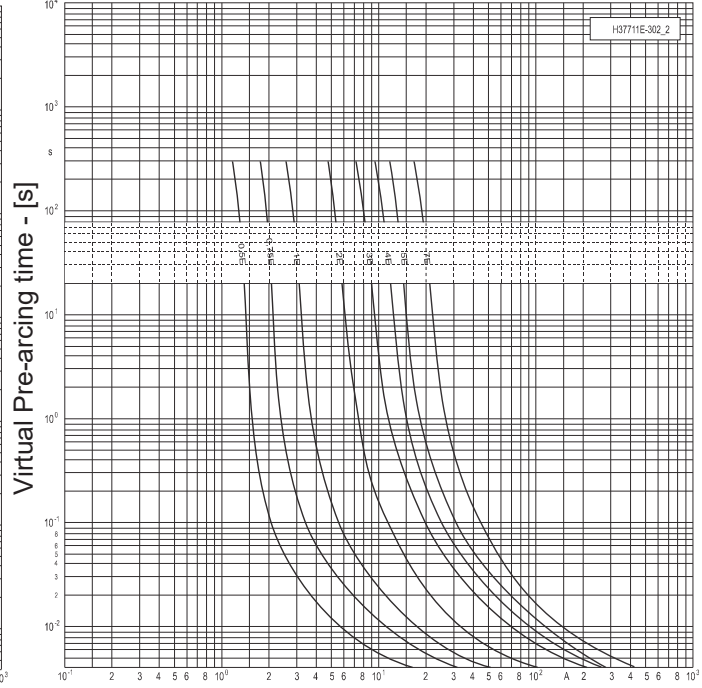

R.M.S. Prospective Current [A]

Full size graphs available upon request.

**HHZ-BVT High Voltage Current-Limiting Fuses Standard(s)**  
**6kV - 36kV - Rated Voltage For PT Transformers IEC 60282-1**  
**without Striker**  
**Class**  
**L = 160mm/250mm/280mm/418mm Back-Up**

Rated current $I_n$ [A]	Article Number	Diameter D [in/mm]	Weight [kg/l]	Rated breaking current $I_1$ [kA]	Minimum breaking current $I_3$ [A]	Pre-arcing $I^2t$ [A <sup>2</sup> s]	Total $I^2t$ @ $0.87U_n(\text{Max})$ [A <sup>2</sup> s]	Power loss [W]	Cold resistance [mΩ]	
<b>6 / 12kV - L = 160mm</b>										
0.1	3044011.0.1	0.87 / 22	0.8	63	1.5	0.035	—	0.35	2.0	20 000
0.3	3044011.0.3	0.87 / 22	0.8	63	3.1	0.36	—	3.6	4.0	3 800
0.5	3044011.0.5	0.87 / 22	0.8	63	4.0	0.4	—	3.4	1.0	3 490
0.6	3044011.0.6	0.87 / 22	0.8	63	4.8	0.6	—	5.1	1.3	2 930
1	3044011.1	0.87 / 22	0.8	63	8	1.8	—	13	2.5	1 650
2	3044011.2	0.87 / 22	0.8	63	16	2.9	—	21	9.0	1 300
3.15	3044011.3.15	0.87 / 22	0.8	63	25	9.2	—	55	12	735
4	3044011.4	0.87 / 22	0.8	63	32	17	—	90	14	540
5	3044011.5	0.87 / 22	0.8	63	40	29	—	116	28	410
6.3	3044011.6.3	0.87 / 22	0.8	63	50	47	—	150	25	325
<b>10 / 24kV - L = 250mm</b>										
0.1	3044311.0.1	0.87 / 22	0.8	63	1.5	0.035	—	0.35	4	40 000
0.3	3044311.0.3	0.87 / 22	0.8	63	3.1	0.36	—	3.6	7	7 700
0.5	3044311.0.5	0.87 / 22	0.8	63	4.0	0.4	—	3.4	1.9	6 980
0.6	3044311.0.6	0.87 / 22	0.8	63	4.8	0.6	—	5.1	2.3	5 860
1	3044311.1	0.87 / 22	0.8	63	8	1.8	—	13	4.2	3 300
2	3044311.2	0.87 / 22	0.8	63	16	2.9	—	21	16	2 600
<b>10 / 24kV - L = 280mm</b>										
0.1	3044111.0.1	0.87 / 22	0.8	63	1.5	0.035	—	0.35	4	40 000
0.3	3044111.0.3	0.87 / 22	0.8	63	3.1	0.36	—	3.6	7	7 700
0.5	3044111.0.5	0.87 / 22	0.8	63	4.0	0.4	—	3.4	1.9	6 980
0.6	3044111.0.6	0.87 / 22	0.8	63	4.8	0.6	—	5.1	2.3	5 860
1	3044111.1	0.87 / 22	0.8	63	8	1.8	—	13	4.2	3 300
2	3044111.2	0.87 / 22	0.8	63	16	2.9	—	21	16	2 600
3.15	3044111.3.15	0.87 / 22	0.8	63	25	9.2	—	55	22.5	1 470
4	3044111.4	0.87 / 22	0.8	63	32	17	—	90	28	1 080
5	3044111.5	0.87 / 22	0.8	63	40	29	—	116	35	820
6.3	3044111.6.3	0.87 / 22	0.8	63	50	47	—	155	48	655
<b>20 / 36kV - L = 418mm</b>										
0.1	3044211.0.1	1.49 / 36.5	0.8	63	1.5	0.035	—	0.35	7	64 000
0.3	3044211.0.3	1.49 / 36.5	0.8	63	3.1	0.36	—	3.6	11	12 500
0.5	3044211.0.5	1.49 / 36.5	0.8	63	4.0	0.4	—	3.4	2.9	10 500
0.6	3044211.0.6	1.49 / 36.5	0.8	63	4.8	0.6	—	5.1	3.5	8 800
1	3044211.1	1.49 / 36.5	0.8	63	8	1.8	—	13	6.3	5 000
2	3044211.2	1.49 / 36.5	0.8	63	16	2.9	—	21	24	3 900

**Dimensions [mm]**

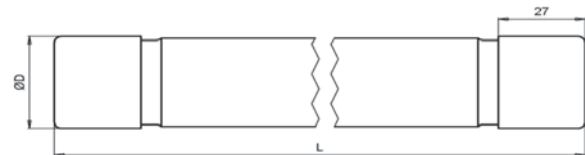

**Accessories**

Article Description	Article Number	D[in/mm]	Page(s)
Fuse clips	6100201.3	0.87 / 22	192
Terminal bar for fuse clips	6300201.4	—	
Clamping plate	6300201	—	
Fuse clips	9109401.3	1.49 / 36.5	
Terminal bar for fuse clips	9109401.4	—	

**HHZ-BVT Time-Current Characteristics - Minimum Melting and Total Clearing  
Cut-Off Current Diagram  
Current-Limiting, Back-Up, 3kV - 36kV (0.5A - 5A)**

3044011.0.1 - 6.3, 3044211.0.1 - 2, 3044311.0.1 - 2, 3044311.0.1 - 6.3

**Average Melting**

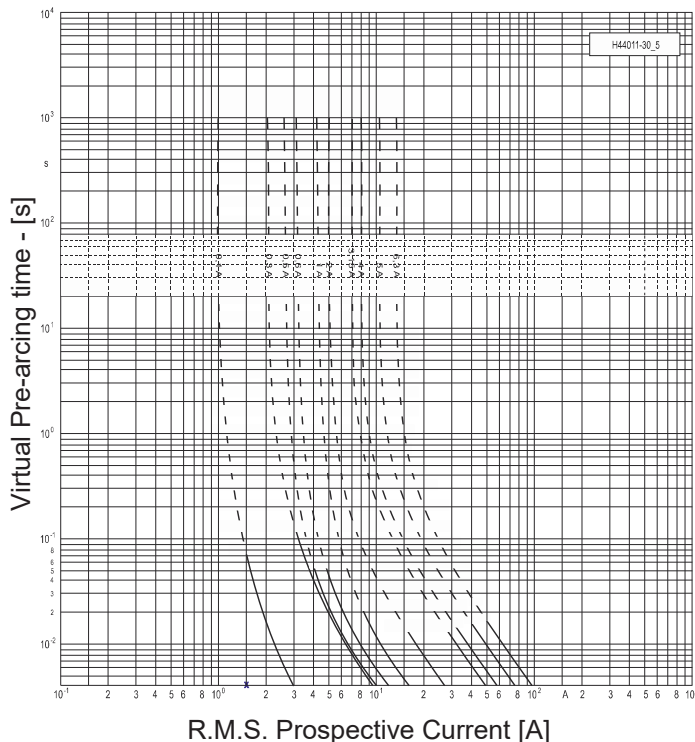

**Cut-Off Current**

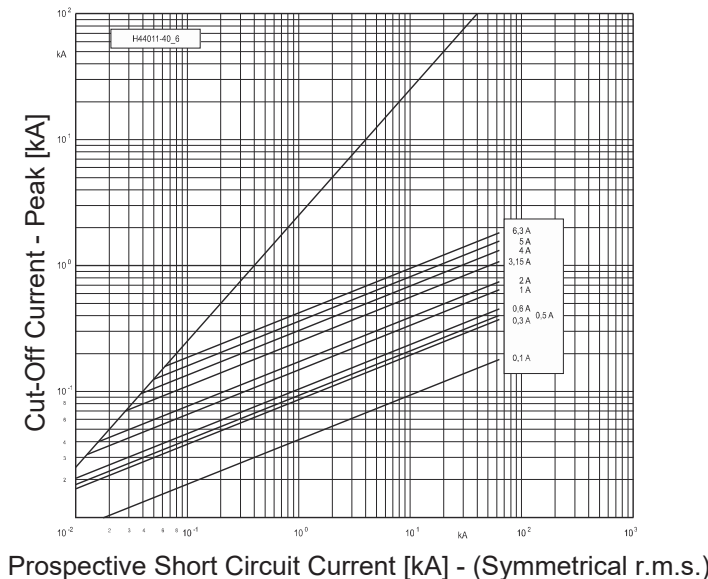

Full size graphs available upon request.



**HHD-BVT**  
3/7.2kV- Rated Voltage

**High Voltage Current-Limiting Fuses**  
For Potential Transformers(PT)

**Standard(s)**  
DIN 43 625  
IEC 60282-1  
VDE 0670-4

**Class**  
**Back-Up**



**E=192mm / 292mm**

Rated current $I_n$ [A]	Article Number	Diameter <b>D</b>	Weight [kg/l]	Rated breaking current $I_1$ [kA]	Minimum breaking current $I_3$ [A]	Pre-arcing $I^2t$ [A <sup>2</sup> s]	Total $I^2t$ @		Power loss <sup>1</sup> [W]	Cold resistance [mΩ]
		[in/mm]					0.87U <sub>n</sub> (Min) [A <sup>2</sup> s]	0.87U <sub>n</sub> (Max) [A <sup>2</sup> s]		
<b>E=192mm W/O Striker</b>										
0.5	3000211.0.5	2.09 / 53	1.2	63	5	1.6	3.2	5.9	3.6	13 250
1	3000211.1	2.09 / 53	1.2	63	8	0.63	1.8	2.8	2.8	2 100
2	3000211.2	2.09 / 53	1.2	63	16	3.2	9.8	12	5.0	935
2.5	3000211.2.5	2.09 / 53	1.2	63	20	7.2	14.5	22	5.2	630
3.15	3000211.3.15	2.09 / 53	1.2	63	24	17	32	48	5.5	420
4	3000211.4	2.09 / 53	1.2	63	32	31	62	90	7.2	310
5	3000211.5	2.09 / 53	1.2	63	40	40	80	125	5.0	141
<b>E-192mm With 80N Striker</b>										
2	3000213.2	2.09 / 53	1.2	63	16	3.2	9.8	12	5.0	935
2.5	3000213.2.5	2.09 / 53	1.2	63	20	7.2	14.5	22	5.2	630
3.15	3000213.3.15	2.09 / 53	1.2	63	24	17	32	48	5.5	420
4	3000213.4	2.09 / 53	1.2	63	32	31	62	90	7.2	310
5	3000213.5	2.09 / 53	1.2	63	40	40	80	125	5.0	141
<b>E=292mm W/O Striker</b>										
0.5	3009811.0.5	2.09 / 53	1.2	63	5	1.6	3.2	5.9	3.6	13 250
1	3009811.1	2.09 / 53	1.2	63	8	0.63	1.8	2.8	2.8	2 100
2	3009811.2	2.09 / 53	1.6	63	16	3.2	9.8	12	5.0	935
2.5	3009811.2.5	2.09 / 53	1.6	63	20	7.2	14.5	22	5.2	630
3.15	3009811.3.15	2.09 / 53	1.6	63	24	17	32	48	5.5	420
4	3009811.4	2.09 / 53	1.6	63	32	31	62	90	7.2	310
5	3009811.5	2.09 / 53	1.6	63	40	40	80	125	5.0	141
<b>E=292mm With 80N Striker</b>										
2	3009813.2	2.09 / 53	1.6	63	16	3.2	9.8	12	5.0	935
2.5	3009813.2.5	2.09 / 53	1.6	63	20	7.2	14.5	22	5.2	630
3.15	3009813.3.15	2.09 / 53	1.6	63	24	17	32	48	5.5	420
4	3009813.4	2.09 / 53	1.6	63	32	31	62	90	7.2	310
5	3009813.5	2.09 / 53	1.6	63	40	40	80	125	5.0	141

<sup>1</sup> At rated current per IEC 60282-1



**Dimensions [mm]**

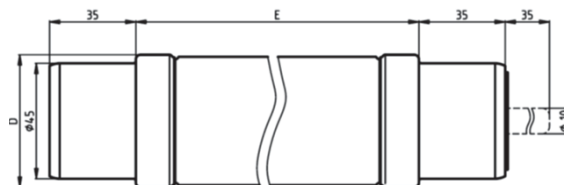

**Accessories**

Article Description	E=192mm	E=292mm	Page(s)
Fuse base, indoor	3100102	3100302	188
Fuse base, outdoor	3100201	3100401	189
Fuse clips	3100302.20		190
Fuse clips w/connecting bar	3400201		
Microswitch fittings, *Preferred	250mm - 3100116, 660mm - 3100110 & 3100210*, 900mm - 3100114, 1200mm - 3100117		187

### HHD-BVT 6/12kV- Rated Voltage

### High Voltage Current-Limiting Fuses For Potential Transformers(PT)

Standard(s)  
DIN 43 625  
IEC 60282-1  
VDE 0670-4

E=192mm / 292mm

Class  
Back-Up



Rated current $I_n$ [A]	Article Number	Diameter <b>D</b>	Weight [kg/l]	Rated breaking current $I_1$ [kA]	Minimum breaking current $I_3$ [A]	Pre-arcing $I^2t$ [A <sup>2</sup> s]	Total $I^2t$ @		Power loss <sup>1</sup> [W]	Cold resistance [mΩ]
		[in/mm]					0.87U <sub>n</sub> (Min) [A <sup>2</sup> s]	0.87U <sub>n</sub> (Max) [A <sup>2</sup> s]		
<b>E=192mm W/O Striker</b>										
0.5	3011911.0.5	2.09 / 53	1.2	63	5	1.6	3.2	5.9	6.1	22 130
1	3011911.1	2.09 / 53	1.2	63	8	0.63	1.2	1.8	4.8	3 510
2	3011911.2	2.09 / 53	1.2	63	16	3.2	6.5	9.8	8.2	1 570
2.5	3011911.2.5	2.09 / 53	1.2	63	20	7.2	15	23	8.9	950
3.15	3011911.3.15	2.09 / 53	1.2	63	24	17	32	48	9.6	700
4	3011911.4	2.09 / 53	1.2	63	32	31	62	90	12	520
5	3011911.5	2.09 / 53	1.2	63	40	40	80	125	8.3	236
<b>E=192mm With 80N Striker</b>										
2	3011913.2	2.09 / 53	1.2	63	16	3.2	6.5	9.8	8.2	1 570
2.5	3011913.2.5	2.09 / 53	1.2	63	20	7.2	15	23	8.9	950
3.15	3011913.3.15	2.09 / 53	1.2	63	24	17	32	48	9.6	700
4	3011913.4	2.09 / 53	1.2	63	32	31	62	90	12	520
5	3011913.5	2.09 / 53	1.2	63	40	40	80	125	8.3	236
<b>E=292mm W/O Striker</b>										
0.5	3000411.0.5	2.09 / 53	1.6	63	5	1.6	3.2	5.9	6.1	22 130
1	3000411.1	2.09 / 53	1.6	63	8	0.63	1.2	1.8	4.8	3 510
2	3000411.2	2.09 / 53	1.6	63	16	3.2	6.5	9.8	8.2	1 570
2.5	3000411.2.5	2.09 / 53	1.6	63	20	7.2	15	23	8.9	950
3.15	3000411.3.15	2.09 / 53	1.6	63	24	17	32	48	9.6	700
4	3000411.4	2.09 / 53	1.6	63	32	31	62	90	12	520
5	3000411.5	2.09 / 53	1.6	63	40	40	80	125	8.3	236
<b>E=292mm With 80N Striker</b>										
2	3000413.2	2.09 / 53	1.6	63	16	3.2	6.5	9.8	8.2	1 570
2.5	3000413.2.5	2.09 / 53	1.6	63	20	7.2	15	23	8.9	950
3.15	3000413.3.15	2.09 / 53	1.6	63	24	17	32	48	9.6	700
4	3000413.4	2.09 / 53	1.6	63	32	31	62	90	12	520
5	3000413.5	2.09 / 53	1.6	63	40	40	80	125	8.3	236

<sup>1</sup> At rated current per IEC 60282-1



### Dimensions [mm]

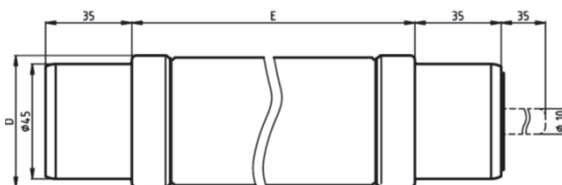

### Accessories

Article Description	E=192mm	E=292mm	Page(s)
Fuse base, indoor	Contact SIBA	3100302	188
Fuse base, outdoor	Contact SIBA	3100401	189
Fuse clips	3100302.20		190
Fuse clips w/connecting bar	3400201		
Microswitch fittings, *Preferred	250mm - 3100116, 660mm - 3100110 & 3100210*, 900mm - 3100114, 1200mm - 3100117		187

**HHD-BVT**  
10/17.5kV- Rated Voltage

**High Voltage Current-Limiting Fuses**  
For Potential Transformers(PT)

Standard(s)  
DIN 43 625  
IEC 60282-1  
VDE 0670-4

E=192mm / 292mm

Class  
Back-Up



Rated current $I_n$ [A]	Article Number	Diameter <b>D</b>	Weight [kg/l]	Rated breaking current $I_1$ [kA]	Minimum breaking current $I_3$ [A]	Pre-arcing $I^2t$ [A <sup>2</sup> s]	Total $I^2t$ @		Power loss <sup>1</sup> [W]	Cold resistance [mΩ]
		[in/mm]					0.87U <sub>n</sub> (Min) [A <sup>2</sup> s]	0.87U <sub>n</sub> (Max) [A <sup>2</sup> s]		
<b>E=192mm W/O Striker</b>										
0.5	3017911.0.5	2.09 / 53	1.2	63	5	1.6	3.2	5.9	8.1	29 480
1	3017911.1	2.09 / 53	1.2	63	8	0.63	1.2	1.8	6.2	4 640
2	3017911.2	2.09 / 53	1.2	63	16	3.2	6.5	9.8	11	2 060
2.5	3017911.2.5	2.09 / 53	1.2	63	20	7.2	15	24	12	1 400
3.15	3017911.3.15	2.09 / 53	1.2	63	24	17	32	48	13	920
4	3017911.4	2.09 / 53	1.2	63	32	31	62	90	16	690
5	3017911.5	2.09 / 53	1.2	63	40	40	80	125	11	314
<b>E=192mm With 80N Striker</b>										
2	3017913.2	2.09 / 53	1.2	63	16	3.2	6.5	9.8	11	2 060
2.5	3017913.2.5	2.09 / 53	1.2	63	20	7.2	15	24	12	1 400
3.15	3017913.3.15	2.09 / 53	1.2	63	24	17	32	48	13	920
4	3017913.4	2.09 / 53	1.2	63	32	31	62	90	16	690
5	3017913.5	2.09 / 53	1.2	63	40	40	80	125	11	314
<b>E=292mm W/O Striker</b>										
0.5	3025511.0.5	2.09 / 53	1.6	63	5	1.6	3.2	5.9	8.1	29 480
1	3025511.1	2.09 / 53	1.6	63	8	0.63	1.2	1.8	6.2	4 640
2	3025511.2	2.09 / 53	1.6	63	16	3.2	6.5	9.8	11	2 060
2.5	3025511.2.5	2.09 / 53	1.6	63	20	7.2	15	24	12	1 400
3.15	3025511.3.15	2.09 / 53	1.6	63	24	17	32	48	13	920
4	3025511.4	2.09 / 53	1.6	63	32	31	62	90	16	690
5	3025511.5	2.09 / 53	1.6	63	40	40	80	125	11	314
<b>E=292mm With 80N Striker</b>										
2	3025513.2	2.09 / 53	1.6	63	16	3.2	6.5	9.8	11	2 060
2.5	3025513.2.5	2.09 / 53	1.6	63	20	7.2	15	24	12	1 400
3.15	3025513.3.15	2.09 / 53	1.6	63	24	17	32	48	13	920
4	3025513.4	2.09 / 53	1.6	63	32	31	62	90	16	690
5	3025513.5	2.09 / 53	1.6	63	40	40	80	125	11	314

<sup>1</sup> At rated current per IEC 60282-1



**Dimensions [mm]**

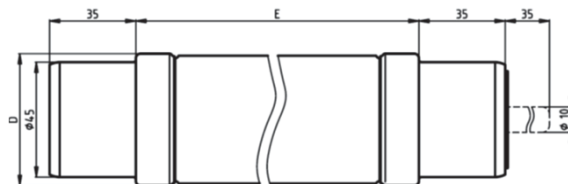

**Accessories**

Article Description	E=192mm	E=292mm	Page(s)
Fuse base, indoor	Contact SIBA	3122101	188
Fuse base, outdoor	Contact SIBA	Contact SIBA	—
Fuse clips	3100302.20		190
Fuse clips w/connecting bar	3400201		
Microswitch fittings, *Preferred	250mm - 3100116, 660mm - 3100110 & 3100210*, 900mm - 3100114, 1200mm - 3100117		187

**HHD-BVT**  
10/17.5kV- Rated Voltage

**High Voltage Current-Limiting Fuses**  
For Potential Transformers(PT)

**Standard(s)**  
DIN 43 625  
IEC 60282-1  
VDE 0670-4



Size E=367mm/442mm

**Class**  
**Back-Up**

Rated current $I_n$ [A]	Article Number	Diameter <b>D</b> [in/mm]	Weight [kg/l]	Rated breaking current $I_1$ [kA]	Minimum breaking current $I_3$ [A]	Pre-arcing $I^2t$ [A <sup>2</sup> s]	Total $I^2t$ @ 0.87U <sub>n</sub> (Min)   0.87U <sub>n</sub> (Max) [A <sup>2</sup> s]	Power loss [W]	Cold resistance [mΩ]
<b>E=367mm W/O Striker</b>									
0.5	3017611.0.5	2.09 / 53	2.0	63	5	1.6	3.2	5.9	29 480
1	3017611.1	2.09 / 53	2.0	63	8	0.63	1.2	1.8	4 640
2	3017611.2	2.09 / 53	2.0	63	16	3.2	6.5	9.8	2 060
2.5	3017611.2.5	2.09 / 53	2.0	63	20	7.2	15	24	1 400
3.15	3017611.3.15	2.09 / 53	2.0	63	24	17	32	48	920
4	3017611.4	2.09 / 53	2.0	63	32	31	62	90	690
5	3017611.5	2.09 / 53	2.0	63	40	40	80	125	314
<b>E=367mm With 80N Striker</b>									
2	3017613.2	2.09 / 53	2.0	63	16	3.2	6.5	9.8	2 060
2.5	3017613.2.5	2.09 / 53	2.0	63	20	7.2	15	24	1 400
3.15	3017613.3.15	2.09 / 53	2.0	63	24	17	32	48	920
4	3017613.4	2.09 / 53	2.0	63	32	31	62	90	690
5	3017613.5	2.09 / 53	2.0	63	40	40	80	125	314
<b>E=442mm W/O Striker</b>									
0.5	3023111.0.5	2.09 / 53	2.0	63	5	1.6	3.2	5.9	29 480
1	3023111.1	2.09 / 53	2.0	63	8	0.63	1.2	1.8	4 640
2	3023111.2	2.09 / 53	2.0	63	16	3.2	6.5	9.8	2 060
2.5	3023111.2.5	2.09 / 53	2.0	63	20	7.2	15	24	1 400
3.15	3023111.3.15	2.09 / 53	2.0	63	24	17	32	48	920
4	3023111.4	2.09 / 53	2.0	63	32	31	62	90	690
5	3023111.5	2.09 / 53	2.0	63	40	40	80	125	314
<b>E=442mm With 80N Striker</b>									
2	3023113.2	2.09 / 53	2.0	63	16	3.2	6.5	9.8	2 060
2.5	3023113.2.5	2.09 / 53	2.0	63	20	7.2	15	24	1 400
3.15	3023113.3.15	2.09 / 53	2.0	63	24	17	32	48	920
4	3023113.4	2.09 / 53	2.0	63	32	31	62	90	690
5	3023113.5	2.09 / 53	2.0	63	40	40	80	125	314

<sup>1</sup> At rated current per IEC 60282-1



**Dimensions [mm]**

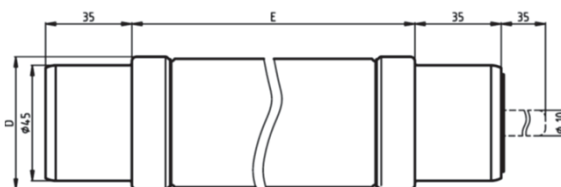

**Accessories**

Article Description	E=292mm	E=357mm	Page(s)
Fuse base, indoor	3122101	Contact SIBA	188
Fuse base, outdoor	Contact SIBA	Contact SIBA	
Fuse clips	3100302.20		190
Fuse clips w/connecting bar	3400201		
Microswitch fittings, *Preferred	250mm - 3100116, 660mm - 3100110 & 3100210*, 900mm - 3100114, 1200mm - 3100117		187

**HHD-BVT**  
10/24kV- Rated Voltage

**High Voltage Current-Limiting Fuses**  
For Potential Transformers(PT)

Standard(s)  
DIN 43 625  
IEC 60282-1  
VDE 0670-4



**E=292mm/442mm**

**Class**  
**Back-Up**

Rated current $I_n$ [A]	Article Number	Diameter <b>D</b>	Weight [kg/1]	Rated breaking current $I_1$ [kA]	Minimum breaking current $I_3$ [A]	Pre-arcing $I^2t$ [A <sup>2</sup> s]	Total $I^2t$ @		Power loss <sup>1</sup> [W]	Cold resistance [mΩ]
		[in/mm]					0.87U <sub>n</sub> (Min) [A <sup>2</sup> s]	0.87U <sub>n</sub> (Max) [A <sup>2</sup> s]		
<b>E=292mm W/O Striker</b>										
0.5	3018011.0.5	2.09 / 53	2.0	63	5	1.6	3.2	5.9	11.2	40 550
1	3018011.1	2.09 / 53	2.0	63	8	0.63	1.2	1.8	8.6	6 450
2	3018011.2	2.09 / 53	2.0	63	16	3.2	6.5	9.8	15	2 850
2.5	3018011.2.5	2.09 / 53	2.0	63	20	7.2	15	26	16	1 920
3.15	3018011.3.15	2.09 / 53	2.0	63	24	17	32	48	18	1 300
4	3018011.4	2.09 / 53	2.0	63	32	31	62	90	22	950
5	3018011.5	2.09 / 53	2.0	63	40	40	80	125	15	433
<b>E=292mm With 80N Striker</b>										
2	3018013.2	2.09 / 53	2.0	63	16	3.2	6.5	9.8	15	2 850
2.5	3018013.2.5	2.09 / 53	2.0	63	20	7.2	15	26	16	1 920
3.15	3018013.3.15	2.09 / 53	2.0	63	24	17	32	48	18	1 300
4	3018013.4	2.09 / 53	2.0	63	32	31	62	90	22	950
5	3018013.5	2.09 / 53	2.0	63	40	40	80	125	15	433
<b>E=442mm W/O Striker</b>										
0.5	3000611.0.5	2.09 / 53	2.3	63	5	1.6	3.2	5.9	11.2	40 550
1	3000611.1	2.09 / 53	2.3	63	8	0.63	1.2	1.8	8.6	6 450
2	3000611.2	2.09 / 53	2.3	63	16	3.2	6.5	9.8	15	2 850
2.5	3000611.2.5	2.09 / 53	2.3	63	20	7.2	15	26	16	1 920
3.15	3000611.3.15	2.09 / 53	2.3	63	24	17	32	48	18	1 300
4	3000611.4	2.09 / 53	2.3	63	32	31	62	90	22	950
5	3000611.5	2.09 / 53	2.3	63	40	40	80	125	15	433
<b>E=442mm With 80N Striker</b>										
2	3000613.2	2.09 / 53	2.3	63	16	3.2	6.5	9.8	15	2 850
2.5	3000613.2.5	2.09 / 53	2.3	63	20	7.2	15	26	16	1 920
3.15	3000613.3.15	2.09 / 53	2.3	63	24	17	32	48	18	1 300
4	3000613.4	2.09 / 53	2.3	63	32	31	62	90	22	950
5	3000613.5	2.09 / 53	2.3	63	40	40	80	125	15	433

<sup>1</sup> At rated current per IEC 60282-1



**Dimensions [mm]**

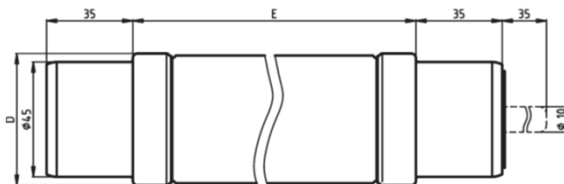

**Accessories**

Article Description	E=292mm	E=442mm	E=537mm	Page(s)
Fuse base, indoor	3122101	3100502	3100702	188
Fuse base, outdoor	Contact SIBA	3100601	3100801	189
Fuse clips	3100302.20			190
Fuse clips w/connecting bar	3400201			
Microswitch fittings, *Preferred	250mm - 3100116, 660mm - 3100110 & 3100210*, 900mm - 3100114, 1200mm - 3100117			187

**HHD-BVT**  
20/36kV- Rated Voltage

**High Voltage Current-Limiting Fuses**  
For Potential Transformers(PT)

**Standard(s)**  
DIN 43 625  
IEC 60282-1  
VDE 0670-4



**E=292mm**

**Class**  
**Back-Up**

Rated current $I_n$ [A]	Article Number	Diameter <b>D</b> [in/mm]	Weight [kg/l]	Rated breaking current $I_1$ [kA]	Minimum breaking current $I_3$ [A]	Pre-arcing $I^2t$ [A <sup>2</sup> s]	Total $I^2t$ @ 0.87U <sub>n</sub> (Min) [A <sup>2</sup> s]	Total $I^2t$ @ 0.87U <sub>n</sub> (Max) [A <sup>2</sup> s]	Power loss <sup>1</sup> [W]	Cold resistance [mΩ]
<b>E=292mm W/O Striker</b>										
0.5	3038211.0.5	2.09 / 53	2.0	40	5	1.6	3.2	5.9	17	60 800
1	3038211.1	2.09 / 53	2.0	40	8	0.63	1.2	1.8	13	9 570
2	3038211.2	2.09 / 53	2.0	40	16	3.2	6.5	9.8	23	4 260
2.5	3038211.2.5	2.09 / 53	2.0	40	20	7.2	21	35	22	2 600
3.15	3038211.3.15	2.09 / 53	2.0	40	24	17	32	48	26	1 900
4	3038211.4	2.09 / 53	2.0	40	32	31	62	90	33	1 420
5	3038211.5	2.09 / 53	2.0	40	40	40	80	125	23	650
<b>E=292mm With 80N Striker</b>										
2	3038213.2	2.09 / 53	2.0	40	16	3.2	6.5	9.8	23	4 260
2.5	3038213.2.5	2.09 / 53	2.0	40	20	7.2	21	35	22	2 600
3.15	3038213.3.15	2.09 / 53	2.0	40	24	17	32	48	26	1 900
4	3038213.4	2.09 / 53	2.0	40	32	31	62	90	33	1 420
5	3038213.5	2.09 / 53	2.0	40	40	40	80	125	23	650

<sup>1</sup> At rated current per IEC 60282-1



### Dimensions [mm]

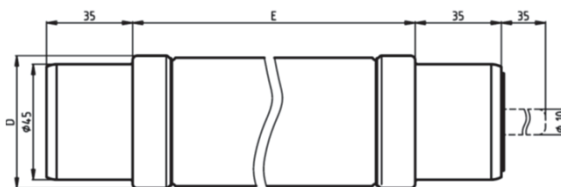

### Accessories

Article Description	E=292mm		Page(s)
Fuse base, indoor	Contact SIBA	—	—
Fuse base, outdoor	Contact SIBA	—	—
Fuse clips	3100302.20		190
Fuse clips w/connecting bar	3400201		
Microswitch fittings, *Preferred	250mm - 3100116, 660mm - 3100110 & 3100210*, 900mm - 3100114, 1200mm - 3100117		187

**HHD-BVT**  
20/36kV- Rated Voltage

**High Voltage Current-Limiting Fuses**  
For Potential Transformers(PT)

**Standard(s)**  
DIN 43 625  
IEC 60282-1  
VDE 0670-4

**Class**  
**Back-Up**



**E=442mm / 537mm**

Rated current $I_n$ [A]	Article Number	Diameter <b>D</b>	Weight [kg/1]	Rated breaking current $I_1$ [kA]	Minimum breaking current $I_3$ [A]	Pre-arcing $I^2t$ [A <sup>2</sup> s]	Total $I^2t$ @		Power loss <sup>1</sup> [W]	Cold resistance [mΩ]
		[in/mm]					0.87U <sub>n</sub> (Min) [A <sup>2</sup> s]	0.87U <sub>n</sub> (Max) [A <sup>2</sup> s]		
<b>E=442mm W/O Striker</b>										
0.5	3018111.0.5	2.09 / 53	2.2	40	5	1.6	3.2	5.9	17	60 800
1	3018111.1	2.09 / 53	2.2	40	8	0.63	1.2	1.8	13	9 570
2	3018111.2	2.09 / 53	2.2	40	16	3.2	6.5	9.8	23	4 260
2.5	3018111.2.5	2.09 / 53	2.2	40	20	7.2	21	35	22	2 600
3.15	3018111.3.15	2.09 / 53	2.2	40	24	17	32	48	26	1 900
4	3018111.4	2.09 / 53	2.2	40	32	31	62	90	33	1 420
5	3018111.5	2.09 / 53	2.2	40	40	40	80	125	23	650
<b>E=442mm With 80N Striker</b>										
2	3018113.2	2.09 / 53	2.2	40	16	3.2	6.5	9.8	23	4 260
2.5	3018113.2.5	2.09 / 53	2.2	40	20	7.2	21	35	22	2 600
3.15	3018113.3.15	2.09 / 53	2.2	40	24	17	32	48	26	1 900
4	3018113.4	2.09 / 53	2.2	40	32	31	62	90	33	1 420
5	3018113.5	2.09 / 53	2.2	40	40	40	80	125	23	650
<b>E=537mm W/O Striker</b>										
0.5	3000811.0.5	2.09 / 53	2.7	40	5	1.6	3.2	5.9	17	60 800
1	3000811.1	2.09 / 53	2.7	40	8	0.63	1.2	1.8	13	9 570
2	3000811.2	2.09 / 53	2.7	40	16	3.2	6.5	9.8	23	4 260
2.5	3000811.2.5	2.09 / 53	2.7	40	20	7.2	21	35	22	2 600
3.15	3000811.3.15	2.09 / 53	2.7	40	24	17	32	48	26	1 900
4	3000811.4	2.09 / 53	2.7	40	32	31	62	90	33	1 420
5	3000811.5	2.09 / 53	2.7	40	40	40	80	125	23	650
<b>E=537mm With 80N Striker</b>										
2	3000813.2	2.09 / 53	2.7	40	16	3.2	6.5	9.8	23	4 260
2.5	3000813.2.5	2.09 / 53	2.7	40	20	7.2	21	35	22	2 600
3.15	3000813.3.15	2.09 / 53	2.7	40	24	17	32	48	26	1 900
4	3000813.4	2.09 / 53	2.7	40	32	31	62	90	33	1 420
5	3000813.5	2.09 / 53	2.7	40	40	40	80	125	23	650

<sup>1</sup> At rated current per IEC 60282-1



**Dimensions [mm]**

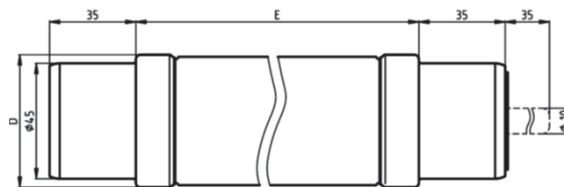

**Accessories**

Article Description	E=442mm	E=537mm	Page(s)
Fuse base, indoor	Contact SIBA	3100702	188
Fuse base, outdoor	Contact SIBA	3100801	189
Fuse clips	3100302.20		190
Fuse clips w/connecting bar	3400201		
Microswitch fittings, *Preferred	250mm - 3100116, 660mm - 3100110 & 3100210*, 900mm - 3100114, 1200mm - 3100117		187

**HHD-BVT**  
38.5kV- Rated Voltage

**High Voltage Current-Limiting Fuses**  
For Potential Transformers(PT)

**Standard(s)**  
DIN 43 625  
IEC 60282-1  
VDE 0670-4



**E=537mm**

**Class**  
**Back-Up**

Rated current $I_n$ [A]	Article Number	Diameter <b>D</b>	Weight [kg/1]	Rated breaking current $I_1$ [kA]	Minimum breaking current $I_3$ [A]	Pre-arcing $I^2t$ [A <sup>2</sup> s]	Total $I^2t$		Power loss <sup>1</sup> [W]	Cold resistance [mΩ]
		[in/mm]					0.87U <sub>n</sub> (Min) [A <sup>2</sup> s]	0.87U <sub>n</sub> (Max) [A <sup>2</sup> s]		
<b>E=537mm W/O Striker</b>										
0.5	3033711.0.5	2.09 / 53	2.7	40	5	1.6	3.2	5.9	23	64 800
1	3033711.1	2.09 / 53	2.7	40	8	0.63	1.2	1.8	14	10 200
2	3033711.2	2.09 / 53	2.7	40	16	3.2	6.5	9.8	25	4 500
2.5	3033711.2.5	2.09 / 53	2.7	40	20	7.2	21	35	27	3 050
3.15	3033711.3.15	2.09 / 53	2.7	40	24	17	32	48	30	2 150
4	3033711.4	2.09 / 53	2.7	40	32	31	62	90	35	1 550
5	3033711.5	2.09 / 53	2.7	40	40	40	80	125	44	1 250
<b>E=537mm With 80N Striker</b>										
2	3033713.2	2.09 / 53	2.7	40	16	3.2	6.5	9.8	25	4 500
2.5	3033713.2.5	2.09 / 53	2.7	40	20	7.2	21	35	27	3 050
3.15	3033713.3.15	2.09 / 53	2.7	40	24	17	32	48	30	2 150
4	3033713.4	2.09 / 53	2.7	40	32	31	62	90	35	1 550
5	3033713.5	2.09 / 53	2.7	40	40	40	80	125	44	1 250

<sup>1</sup> At rated current per IEC 60282-1



**Dimensions [mm]**

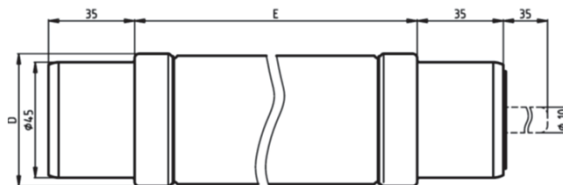

**Accessories**

Article Description	E=537mm		Page(s)
Fuse base, indoor	Contact SIBA	—	—
Fuse base, outdoor	3134001	—	189
Fuse clips	3100302.20		190
Fuse clips w/connecting bar	3400201		
Microswitch fittings, *Preferred	250mm - 3100116, 660mm - 3100110 & 3100210*, 900mm - 3100114, 1200mm - 3100117		187



**HHD-BVT**  
40.5kV- Rated Voltage

**High Voltage Current-Limiting Fuses**  
For Potential Transformers(PT)

**Standard(s)**  
DIN 43 625  
IEC 60282-1  
VDE 0670-4

**Class**  
**Back-Up**



**E=537mm**

Rated current $I_n$ [A]	Article Number	Diameter <b>D</b>	Weight [kg/1]	Rated breaking current $I_1$ [kA]	Minimum breaking current $I_3$ [A]	Pre-arcing $I^2t$ [A <sup>2</sup> s]	Total $I^2t$ @		Power loss <sup>1</sup> [W]	Cold resistance [mΩ]
		[in/mm]					0.87U <sub>n</sub> (Min) [A <sup>2</sup> s]	0.87U <sub>n</sub> (Max) [A <sup>2</sup> s]		
<b>E=537mm W/O Striker</b>										
0.5	3034011.0.5	2.09 / 53	2.7	40	5	1.6 3	2	5.9	24	64 800
1	3034011.1	2.09 / 53	2.7	40	8	0.63	1.2	1.8	15	10 200
2	3034011.2	2.09 / 53	2.7	40	16	3.2	6.5	9.8	27	4 800
2.5	3034011.2.5	2.09 / 53	2.7	40	20	7.2	21	35	28	3 250
3.15	3034011.3.15	2.09 / 53	2.7	40	24	17	32	48	32	2 270
4	3034011.4	2.09 / 53	2.7	40	32	31	62	90	36	1 620
5	3034011.5	2.09 / 53	2.7	40	40	40	80	125	47	1 340
<b>E=537mm With 80N Striker</b>										
2	3034013.2	2.09 / 53	2.7	40	16	3.2	6.5	9.8	27	4 800
2.5	3034013.2.5	2.09 / 53	2.7	40	20	7.2	21	35	28	3 250
3.15	3034013.3.15	2.09 / 53	2.7	40	24	17	32	48	32	2 270
4	3034013.4	2.09 / 53	2.7	40	32	31	62	90	36	1 620
5	3034013.5	2.09 / 53	2.7	40	40	40	80	125	47	1 340

<sup>1</sup> At rated current per IEC 60282-1



**Dimensions [mm]**

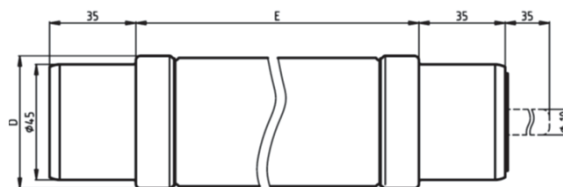

**Accessories**

Article Description	E=537mm		Page(s)
Fuse base, indoor	Contact SIBA	—	—
Fuse base, outdoor	3134001	—	189
Fuse clips	3100302.20		190
Fuse clips w/connecting bar	3400201		
Microswitch fittings, *Preferred	250mm - 3100116, 660mm - 3100110 & 3100210*, 900mm - 3100114, 1200mm - 3100117		187

HHD-BVT

Time-Current Characteristics - Average Melting

Cut-Off Current Diagram

Current-Limiting, Back-Up, 3/7.2kV - 40.5kV, (0.5A - 5A)



30xxx11.0.5 - 5; xxx = 002, 004, 006, 008, - , 119, 176, 179, 180, 181, 221, 255, 282, 337, 340  
 30xxx13.2- 5; xxx = 002, 004, 006, 008, 098, 119, 176, 179, 180, 181, 221, 255, 282, 337, 340

Average Melting

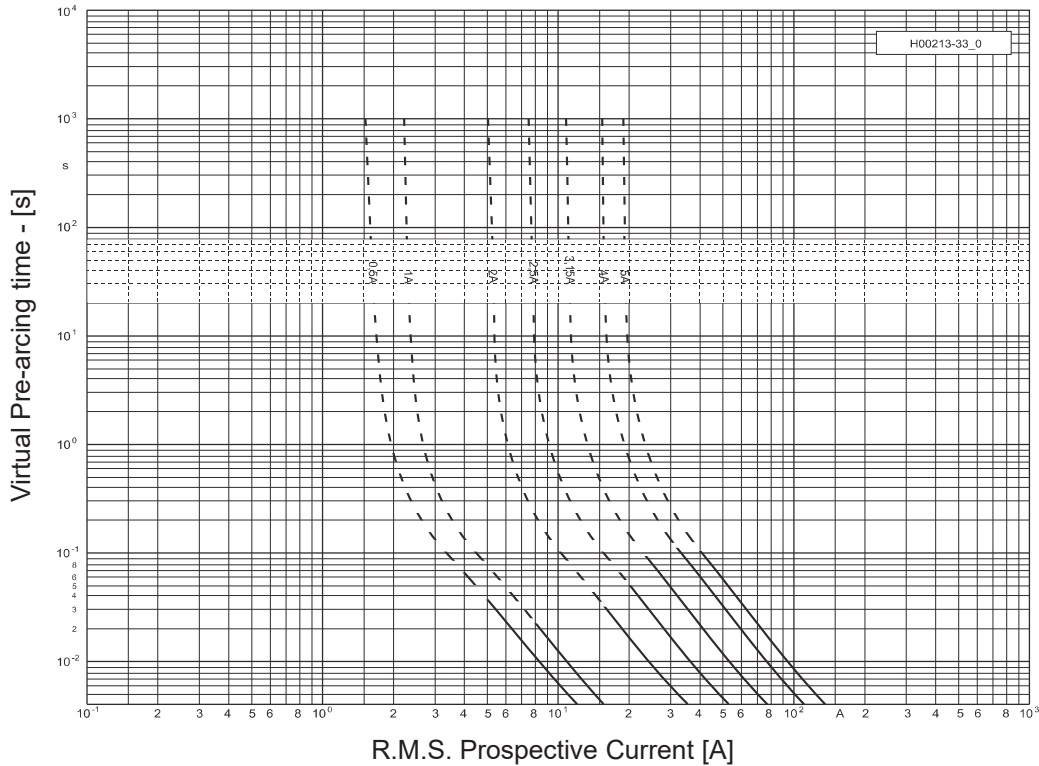

Cut-Off Current

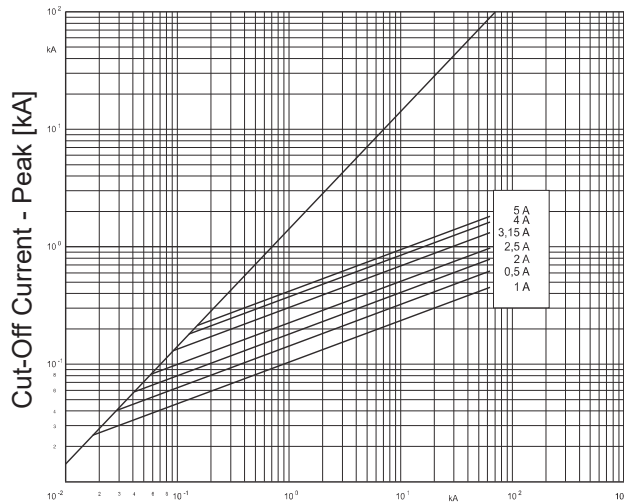

Prospective Short Circuit Current [kA] - (Symmetrical r.m.s.)

Full size graphs available upon request.

SIBA LLC

29 Fairfield Place  
 West Caldwell, New Jersey 07006

portal: [www.siballc.net](http://www.siballc.net)  
 e-mail: [info@sibafuse.com](mailto:info@sibafuse.com)